



PLANETA

BEST-LIFTING PRODUCTS

18





About us	1
Lever hoist PLX-II	2
Lever hoist PAH	3
Manual chain hoist PULLMASTER-II	4
Grip puller	6
Beam clamps BR & BK	7
Trolleys PTM & GTM	8
Electric chain hoist MONTI	9
Electric rope winch BW 160-L	10
Electric rope winch PFW-C	11
Brake winch BHW	13
Manual rope winches AFD & MR/GM	14
Flat webbing slings	15
Round slings	16
Ratchet lashing	17
Plate clamps SLC & VLC	20
Plate clamps HPC-2 & HPC-4	21
Plate clamps MPC & RTG	22
Plate clamps RG & PPC	23
Barrel clamps DLC & DL	24
Magnetic lifter PML	25
Hydraulic jacks A3-WH & HM	26
Mechanical steel jacks	27

Note: PLANETA are constantly striving to increase and further improve the product range.

Whilst every effort has been made to ensure the accuracy of the specifications and dimensions included at the time of printing, we are unable to warrant the given information. Designs and specifications are subject to change without notice or obligation. The inclusion of any product does not guarantee the availability of that product in the future. Customers should check both the availability and conformance of the product to any critical parameters at the time of ordering!

Quality by tradition

Stability and innovation. In truth, they are two sides of the same coin because continuous readiness for innovation enables sustainable developments.

Sustainability, reliability and responsibility are the basic values that we are committed to here at PLANETA. In all periods of the company's history, these values have been personified by our employees and their quest to always do the good things that little bit better.



PLANETA manual chain hoists from 1950 to today

Trust is good – Control is better

PLANETA rope winches are subject to the strictest quality controls and are also designed with high functionality for the toughest operating conditions.

Only quality products that have been tested with an appropriate excess load in compliance with all standards are supplied.



Quality means safety

Reliability and responsibility are the values that we are particularly committed to.

This begins with work safety during production, up to certification of all processes as part of the annual TÜV DIN EN ISO 9000:2001 audit or membership in the GKS.



Your satisfaction is our success

A large network of consultants, service technicians and specialist dealers trained by PLANETA is available to you.

We strive to provide you with the best solution at the best possible price, and this goes well beyond the product itself. To us, best quality means always showing you the solution which corresponds to your requirements.

As one of Germany's oldest lifting device manufacturers, we strive to do this for you each and every day.



Full Member



PLX-II 1.5 t

PLX-II 6 t

PLANETA – PLX-II lifting and anchoring device

The **PLANETA PLX-II** lever hoist is an extremely versatile lifting and anchoring device but is easy to handle.

It is used in the industrial area, in commercial transport, as an aid during assembly and in construction and the trades.

This device stands out thanks to the high quality of serial production and its long service life even if operational demands are high.

Simple free-running mode

When the selection switch is moved to the middle point, the unladen chain can easily be pulled through the device freely.

New chain end piece

In the unlikely case of a brake failure, this serves as an additional safety device because it cannot be pulled through the device with the load chain and therefore the load is held reliably.

Connecting parts

Galvanised screws, nuts and bolts prevent corrosion, even if used outdoors.

Rotatable hooks

The forged carrying and load hooks made of heat-treated, tempered steel are fully rotatable and equipped with spring-loaded, galvanised hook clips.

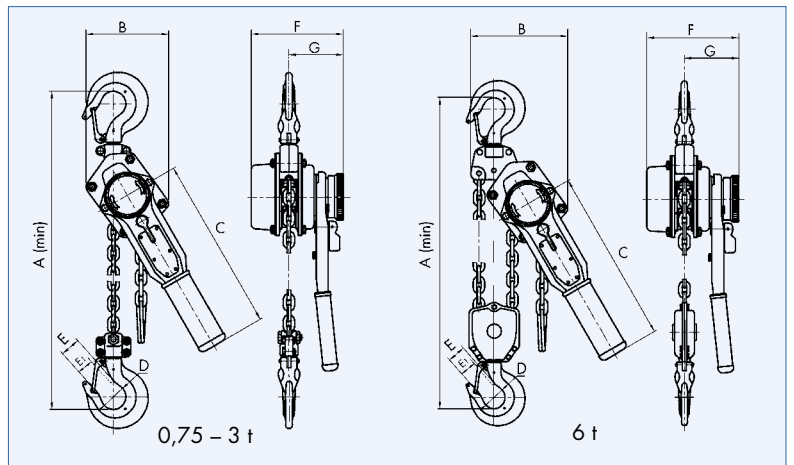

TYPE	PLX-II...	0.75	1.5	3	6
Capacity	kg	750	1,500	3,000	6,000
Standard lift	m	1.5	1.5	1.5	1.5
Min. headroom (A)	mm	340	360	480	600
Lever force	daN	20	26	38	39
Meters load chain movement with 1 round 360°	m	0.018	0.019	0.024	0.012
Number of chain falls		1	1	1	2
Chain size	mm	6 x 18	7.1 x 21	10 x 30	10 x 30
B (Dimensions)	mm	135	160	210	250
C	mm	296	420	420	420
D	mm	37	37	47	69
E	mm	23.7	31.6	35.3	46
E1	mm	18.9	27.2	30.8	41.2
F	mm	150	170	190	190
G	mm	90	98	105	105
Weight with Standard lift	kg	6.8	10.8	19.6	29
Weight for 1 m add. lifting height	kg	0.8	1.1	2.2	4.4
PLX-II ... with 1.5 m lift	Order No.	G10230	G10231	G10232	G10233
Additional 1 m lift	Order No.	G10009	G10068	G10011	G10012

PLANETA – PAH aluminium ratchet lever hoist

The new PLANETA PAH aluminium ratchet lever hoist is an essential tool in industrial and service applications thanks to its very small and light design.

A closed, well-designed aluminium die-cast housing protects the inner components against dirt. Equipped with two robust hook clips, the PAH meets all safety requirements and guarantees safe work.

The new robust chain end piece provides additional safety because the chain cannot be pulled through the device in this way.

A release lever enables the chain to be pulled through quickly when not under load.

Usable at ambient temperatures from -20 °C to +60 °C.

Hand lever with rubber handle (only for 250 kg/500 kg load bearing capacity)

The standard lift is 1.5 m

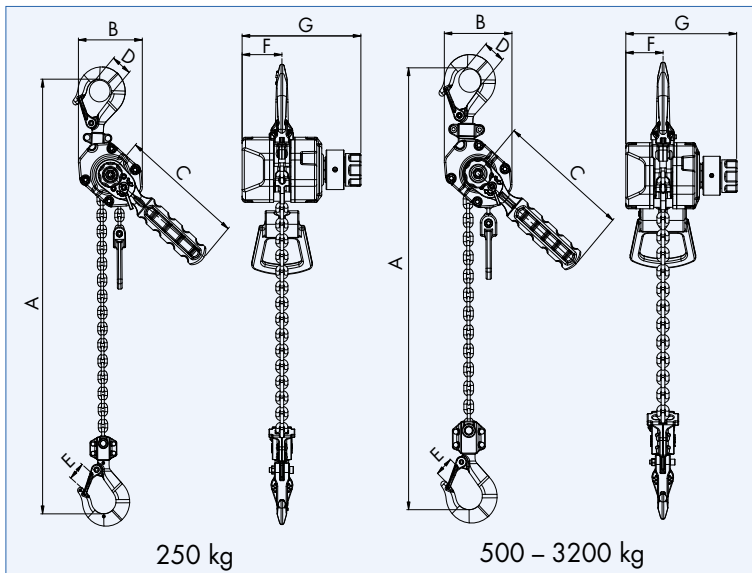

TYPE	PAH ...	250	500	800	1600	3200
Capacity	kg	250	500	800	1,600	3,200
Standard lift	m	1.5	1.5	1.5	1.5	1.5
Min. headroom (A)	mm	223	282	329	355	445
Lever force	daN	17	20	22	25	34
Number of chain falls		1	1	1	1	1
Chain size	mm	3 x 9	4 x 12	5.6 x 17	7.1 x 21	9 x 27*
B (dimensions)	mm	74	90	115	140	170
C	mm	142	175	233	233	350
D	mm	30	35	39	44	60
E	mm	20	22	28	30	41
F	mm	36	40	55	70	88
G	mm	105	117	140	158	185
Weight with standard lift	kg	1.6	2.7	5.1	7.6	14.7
Weight for 1 m add. lift. height	kg	0.2	0.35	0.68	1.1	1.8
PAH ... with 1.5 m lift	Order No.	G10460	G10461	G10462	G10463	G10464
Additional 1 m lift	Order No.	G10465	G10007	G10086	G10087	G10249

* grade 100



Incl. practical bag for the models PAH 250 & 500



PLANETA – PULLMASTER-II

The manual chain hoist **PLANETA – Pullmaster-II** is our valued price alternative to many hoists on the market. It complies fully with all relevant. International standards and the CE-regulations for Europe. Its solid design and easy way of handling made him many friends through the last years. You will find **Pullmaster-II** in many kinds of industry, shipyards, on cranes and also for maintenance.

Safety brake

The large sized safety brake works instantly when operation is wstopped, holding the load safely in any position.

Reliable material

The housings are made of steel, the hook holder and sheeves are of cast steel. This makes **Pullmaster-II** robust and sturdy.

Swivel hook

Top and bottom hook are out of tempered high tensile steel. They have spring loaded, galvanized safety latches with side bending protection.

Luxery rust protection

Screws, nuts, discs, washers, bolts, the complete middle section and the chains are galvanized to offer a reliable corrosion protection. All other steel parts are painted or powder-coated with our best blue finish. Top quality load chain accords to EN 818-7-T and shines zinc galvanized.



PULLMASTER-II
1 t



PULLMASTER-II
0,5 t



PULLMASTER-II
5 t



PULLMASTER-II
2 t

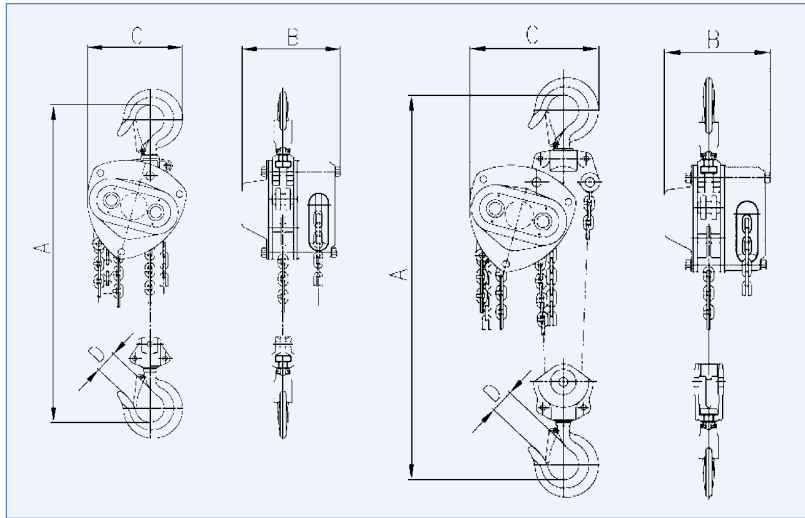

TYPE	PULLMASTER-II ...	0.5	1	1.5	2	3	5	10
Capacity	kg	500	1,000	1,500	2,000	3,000	5,000	10,000
Standard lift	m	3	3	3	3	3	3	3
Min. headroom (A)	mm	285	332	410	455	530	620	737
Hand chain force	daN	19	24	33	24	33	32	32
Hand chain operation length	m	2.5	2.5	2.5	2.5	2.5	2.5	2.5
Meters hand chain to pull to lift 1m	m	25.5	41.5	44.8	82.9	89.6	154.9	309.7
Number of chain falls		1	1	1	2	2	2	4
Chain size	mm	5 x 15	6 x 18	8 x 24	6 x 18	8 x 24	10 x 30	10 x 30
C (Dimensions)	mm	120	147	181	147	181	224	373
B	mm	116	136	147	136	147	177	177
D	mm	28	32	38	40	45	50	64
Weight with Standard lift	kg	7.5	11.5	15.8	16	22	37	68
Weight for 1 m additional lifting height	kg	1.3	1.6	2.2	2.4	3.6	5.2	9.6
PULLMASTER-II ... with 3 m lift	Order No.	G10530	G10531	G10538	G10532	G10533	G10534	G10535
Additional 1 m lift	Order No.	G10241	G10242	G10243	G10244	G10536	G10246	G10537

Chain bag upon request.

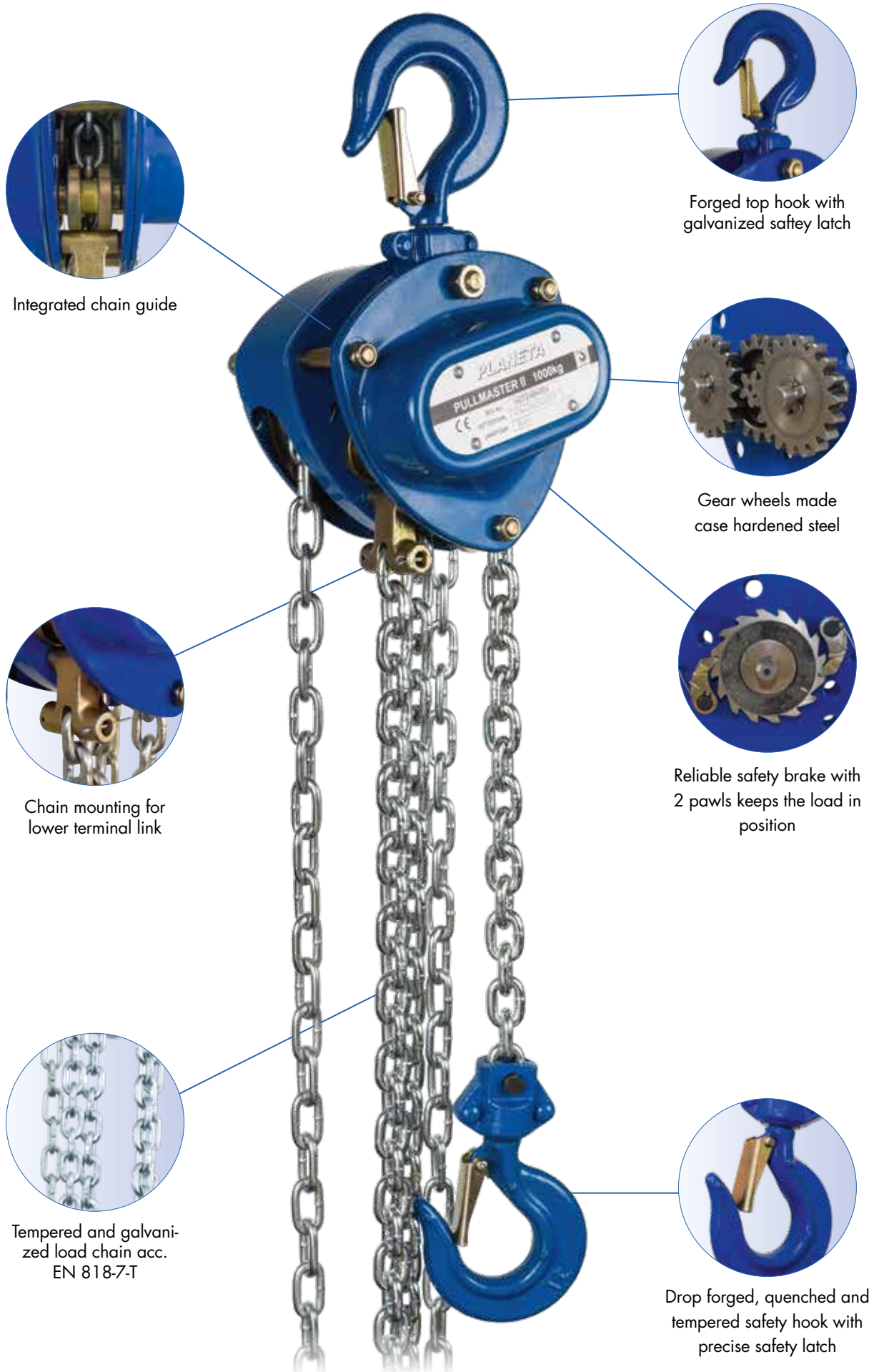

Integrated chain guide



Forged top hook with galvanized safety latch



Gear wheels made case hardened steel

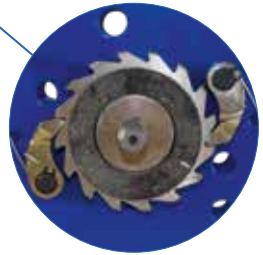

Reliable safety brake with 2 pawls keeps the load in position



Chain mounting for lower terminal link

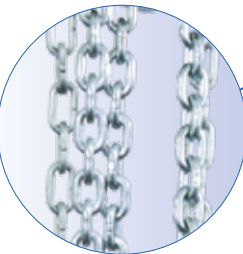

Tempered and galvanized load chain acc. EN 818-7-T



Drop forged, quenched and tempered safety hook with precise safety latch

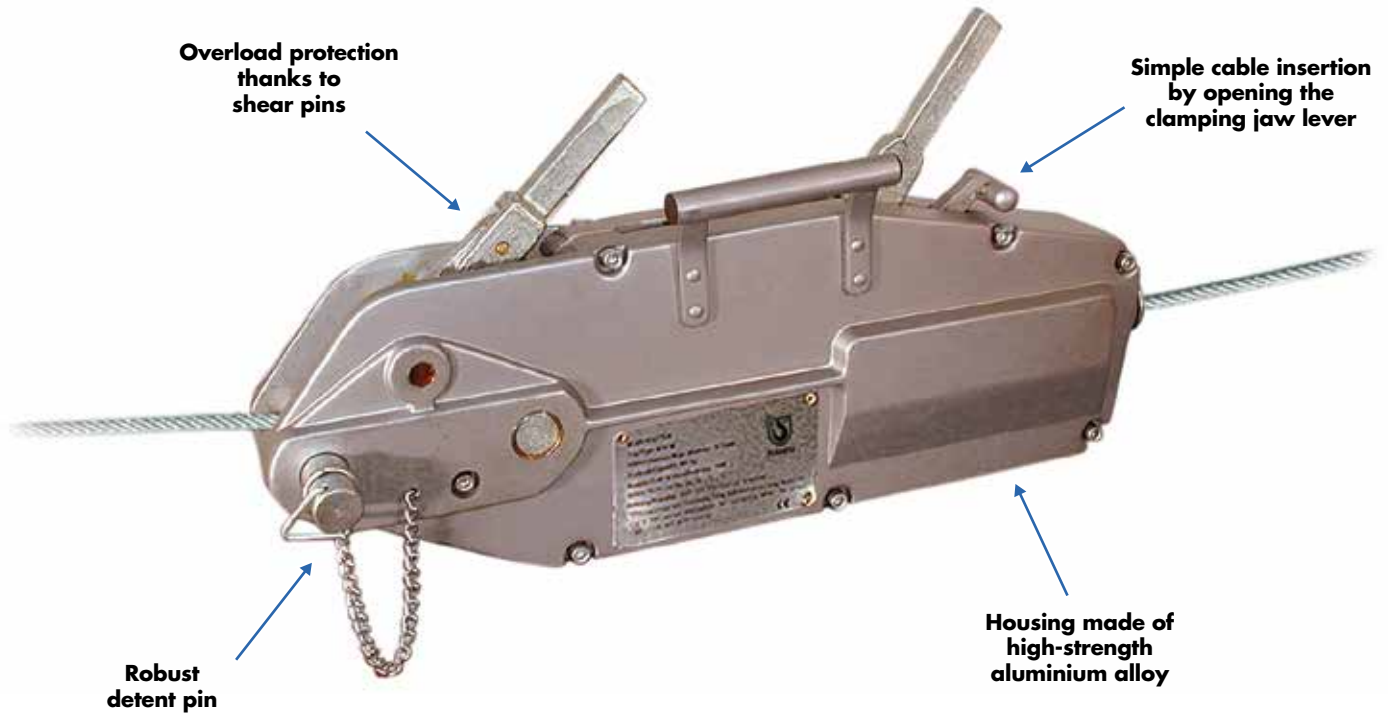

PLANETA – Aluminium ROPEMASTER

The housing is made of corrosion resistant lightweight durable aluminium die cast. This makes the hoist very robust and light enough to carry it around the job. We supply the puller complete with lever and spare overload protection pins, stowed conveniently inside the cap of the lever grip or carrying handle. The wire rope, wounded on a reel with hook, is optional.

Versatile

Cranes lift, winches pull, lever hoists span and tie.

A **PLANETA - ROPEMASTER** is all in one! Four capacities up to 5.4 tons are offered and if you need more power, then wire rope blocks can multiply the force. See the picture below how 10 tons can be moved! Please ask us for sheaves.

Simple operation

The unloaded ROPEMASTER allows you to pull the rope through the body quickly and to the right distance. Now anchor your ROPEMASTER safely! The long rope provides lots of play. Put the long lever pipe on handle 1 for pulling, on handle 2 for lowering. Simply pump the lever. Whenever you stop, the load will be held safely. It's that easy!

Overload protected

Protection pins in handle 1 break if the load is too high. No more pulling or lifting is possible then. But the break function is still active. Just replace the pin quickly without unloading the puller.

Optional accessories

- Sling per DIN 3088
- Shackle to secure the device
- Round slings as of page 16
- Cable winch box

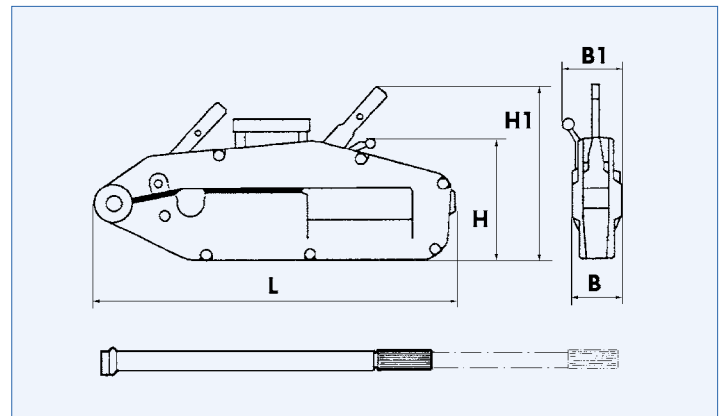

TYPE		RM08	RM16	RM32	RM54
Capacity	kg	800	1,600	3,200	5,400
Rope movement per lever action	mm	60	60	40	25
Lever force at full load	daN	24	30	50	85
Lever length	mm	800	1,200	1,200	1,200
Rope diameter	mm	8.5	11	16	20
Weight of rope	kg/m	0.29	0.53	1	1.65
Standard rope length	m	20	20	20	20
B (Dimensions)	mm	60	72	91	116
B1	mm	-	97	110	150
H	mm	168	190	230	280
H1	mm	240	270	330	390
L	mm	430	545	680	830
Weight without rope	kg	7	14	21	61
Weight with rope and lever	kg	16	28	52	95
RM Puller without rope	Order No.	G10100	G10101	G10102	G10114
RM Puller with 20 m rope	Order No.	G10103	G10104	G10105	G10115
Guide roller	Order No.	D01160	D01162	D01162	D01169

PLANETA – Beam clamp BK

Mobile attachment device

The girder clamp BK is a simple and safe load attachment tool. Its easy two-step operation makes it ideal for urgent tasks and assembly jobs. Twist and open the spindle to the width of the beam flange, push over the flange and close tightly. The clamp can also be used for the lifting and transfer of steel beams and as a pulling clamp.



Typ BK

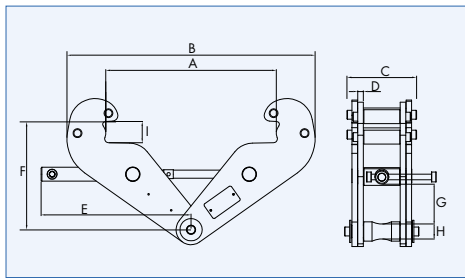

Attachment point

Attachment points can be established quickly to hold hoists and deflection pulleys on a wide range of beams, transporting beams and corresponding bearing structures, fast preparation of cross-beams – in particular for asymmetrical load distributions, preventing and damage to cables and chains.

Short set-up time

For assembly and repair work, beam clamps with changeable clamping ranges are ideal tools. The set-up times are shortened and missing, often improvised attachments points become safer.

Features

The frame of the beam clamp is made from solid steel plates and the spindle is made from high tensile galvanized steel that normally forgives a strong tightening.

TYPE	BK...	10	20	30	50	100
Capacity	kg	1,000	2,000	3,000	5,000	10,000
Grip range A min.	mm	75	75	80	90	90
Grip range A max.	mm	230	230	320	320	320
Flange width		20.8	20.8	34.3	34.3	42.7
B (Dimensions)	mm	180	180	220	220	250
B max.	mm	375	375	498	498	514
C	mm	80	90	117	127	139
D	mm	5	5	8	10	16
E	mm	220	220	271	271	280
F min.	mm	102	102	168	168	172
F max.	mm	160	160	240	240	242
G min.	mm	29	28	60	57	55
H	mm	20	22	24	30	40
Weight	kg	4	5	9	11	18
Order No.		F00031	F00032	F00033	F00034	F00035

PLANETA – Trolley BR

Trolley BR = clamp on wheels

The grip trolley type BR with its integrated push trolley is used as a helper for all kind of mounting, assembly and erection work.



Typ BR

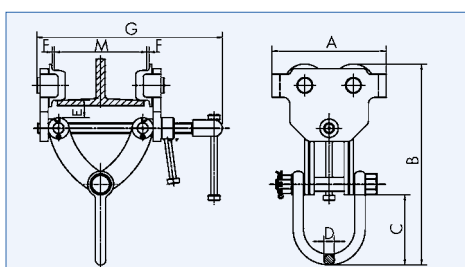

Setting to the beam flange width is performed by rotating the threaded spindle. For security, the locking lever is turned against the side plate. It can be adjusted to a wide beam area and different profiles (e.g. INP, IPE and IPB).

Optimum run

The mechanically machined steel rollers and the closed ball bearings are permanently lubricated.

The spindle is protected against corrosion by zinc galvanization.

Accident prevention regulation safety

The beam clamp with integrated roller carriage complies with the accident prevention regulations for perpendicular lifting. Each model BR clamp is tested with excess loads. The devices are delivered with a test certificate specifying the serial number and an operating manual with an integrated EC Declaration Of Conformity.

TYPE	BR...	10	20	30	50
Capacity	kg	1,000	2,000	3,000	5,000
Grip range M min.	mm	64	76	76	100
Grip range M max.	mm	203	203	203	305
Curve radius	m	1.1	1.3	1.4	1.5
A (Dimensions)	mm	174	280	340	385
B min./max.	mm	263 – 324	339 – 387	374 – 438	450 – 528
C	mm	105	111	127	135
D	mm	Ø 16	Ø 22	Ø 27	Ø 35
E	mm	25.4	25.4	26	81
F	mm	≈ 3	≈ 3	≈ 3	≈ 3
G	mm	340	340	345	465
Weight	kg	7	19.5	32	53
Order No.		F00042	F00036	F00037	F00039

The beam and roller clamps shown are designed for use with manual hoists.



Push trolley
PTM 0.5



Gear type
trolley
GTM 0.5

PTM- & GTM-Trolleys

The manual trolleys are moved against the load by pressing; on the reel chain trolley, pulling the endless manual chain moves the goods to be transported to the right or left. The PREMIUM PRO hoists with the same load bearing capacity can be attached to and removed from the longitudinal eye without problems using the hook, which compensates for swinging loads. The manual chains are galvanised to protect the user and for a long service life. Installation is performed by sliding onto the open beam.

Robust side plates

Balanced load distribution on four wheels thanks to self-adjusting links around the bolt axis! Four safety tabs on the ends of the side plates are used as wheel-break supports, rail cleaners and fall protection.

Ball bearings

The cast iron wheels are quiet and safe due to the lifetime lubricated, sealed ball bearings. They ensure that the trolleys run smoothly and safely.

Large flange adjustability

PTM- & GTM-trolleys are adjustable for various beam sizes by simply changing the number of spacers. The standard bolts are for small flange widths, size 2 bolts allow the use on wider flanges like high HE-B-girders with 300 mm widths (for special beams: additional charge on request). A starting buffer can be supplied as an option.

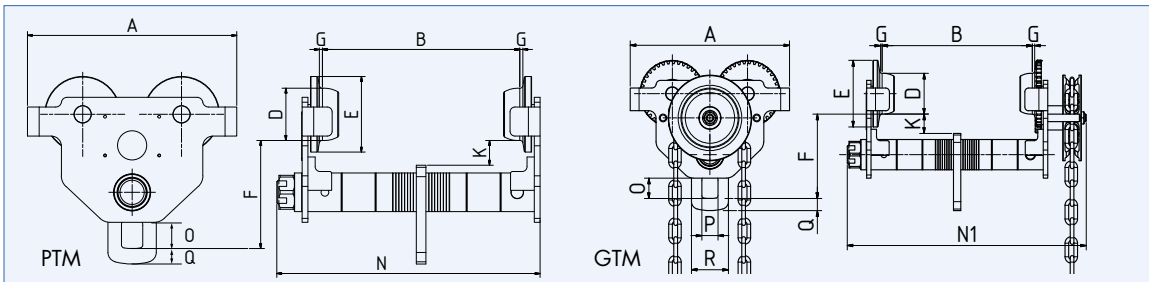

From a capacity of 10 tons
with 360° chain guide
Picture similar!

TYPE	Push trolley PTM...	0.5	1	2	3	5	10	-
TYPE	Gear type trolley GTM...	0.5	1	2	3	5	10	20
Capacity	kg	500	1,000	2,000	3,000	5,000	10,000	20,000
Flange width B min. – max. PTM / GTM	mm	50 – 203 / 64 – 203	64 – 203	88 – 203	100 – 203	114 – 203	124 – 203	136 – 203
Min. Curve radius	m	0.8	0.9	1	1.2	1.3	1.7	2.8
Hand chain operation length GTM	m	2.5	2.5	2.5	2.5	2.5	2.5	2.5
Reel path for 1 m path GTM	m	3	3.6	4.7	5.7	6.3	8	10.6
A (Dimensions)	mm	200	236	276	326	380	426	522
D	mm	54	67	80	100	109	133	170
E	mm	78	96	110	133.5	145	176	227.5
F	mm	111	134	162.5	186	224	198	248
G	mm	3	3	3	4	4.5	4.5	4
K	mm	25	34	28	32	38	50	58
N	mm	281	292	305	321	327.5	341	-
N1	mm	339	351	362	375	386	410	466
O	mm	30	38	55	66	77	108	113
P	mm	22	30	37	42	50	86	106
Q	mm	16	20	25	26.5	34	48	57
R	mm	50	70	90	100	120	-	-
Weight PTM	kg	7	10.5	17.5	27	41	74	-
Weight GTM	kg	14.5	14.5	21.5	31	46	79	173
PTM	Order No.	G20000	G20001	G20002	G20003	G20004	G20005	-
GTM with 2.5 m operation length	Order No.	G20006	G20007	G20008	G20009	G20010	G20011	G20012
Large flange width min. – max.	mm	64 – 305	64 – 305	88 – 305	100 – 305	114 – 305	124 – 305	136 – 305
	Order No.	G20013	G20014	G20015	G20016	G20018	G20019	G20047
Add. hand chain op. length/m	Order No.	G20017	G20017	G20017	G20017	G20017	G20017	G20017

More capacities upon request.

The manual trolleys shown are designed for use with manual hoists.

MONTI

The new MONTI electric chain hoist is the ideal aid during assembly. Thanks to its light and compact construction, the chain hoist is easy to install and transport in the case supplied. It is ready for operation with a controller, chain and connection cable.

Features:

- 230 V / 1ph / 50 Hz motor
- Soft start enables accurate placement
- 2 speeds: Main hoisting speed / precision hoisting speed infinitely adjustable
- Protection class IP 54, insulation class F
- 24-volt control voltage with EMERGENCY STOP
- FEM classification M4 (1Am)
- Control cable length: 2.5 m
- Connection cable with two-pin earthed plug: 1.5 m
- Overload protection by slipping clutch
- Limit switch for top and bottom hook end position
- Includes chain box for 3 m standard lifting height and transport case



Specifications:

TYPE	MONTI	240	480
Rated load	kg	240	480
Motor output	W	600	
Duty rating	% ED	30	
Rated Current		230 V (5 A)	
Lifting speed	m/min.	0-3.4/12.8	0-1.6/6.3
Standard lifting height	m	3	
Number of chain falls		1	2
Load chain diameter	mm	4 x 12	
Net weight	kg	16.5	19.4
Packing (L x W x H)	mm	470 x 390 x 200	
MONTI ... with 3 m lift	Order No.	H20780	H20781
Additional for more lift/m	Order No.	H20782	H20783
Additional for 3 m Set of control cable elongation	Order No.	H20784	H20784
Additional for 6 m Set of control cable elongation	Order No.	H20785	H20785
Additional for 9 m Set of control cable elongation	Order No.	H20786	H20786



Chain box selection

TYPE MONTI...	Rated load	Chain (mm)	Chain length (m)		
			up to 6	up to 12	up to 36
240	240 kg	Ø 4 x 12	# 1	# 2	# 3
480	480 kg				

Chain box No.	Chain box dimensions (mm) L x W x H	Order No.
# 1	90 x 120 x 230	H20790
# 2	120 x 160 x 230	H20791
# 3	140 x 170 x 400	H20793

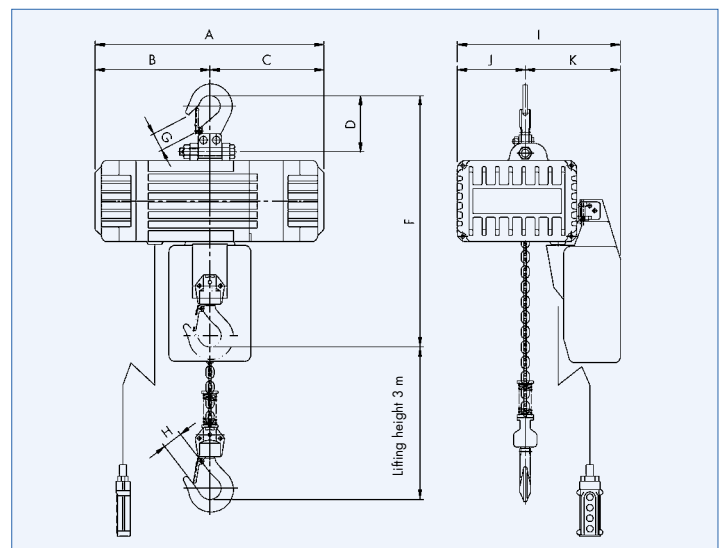

TYPE MONTI...	Dimensions (mm)									
	A	B	C	D	F	G	H	I	J	K
240	364	182	182	89	400	25	25	260	108	152
480	364	182	182	109	497	31	30	260	84	176

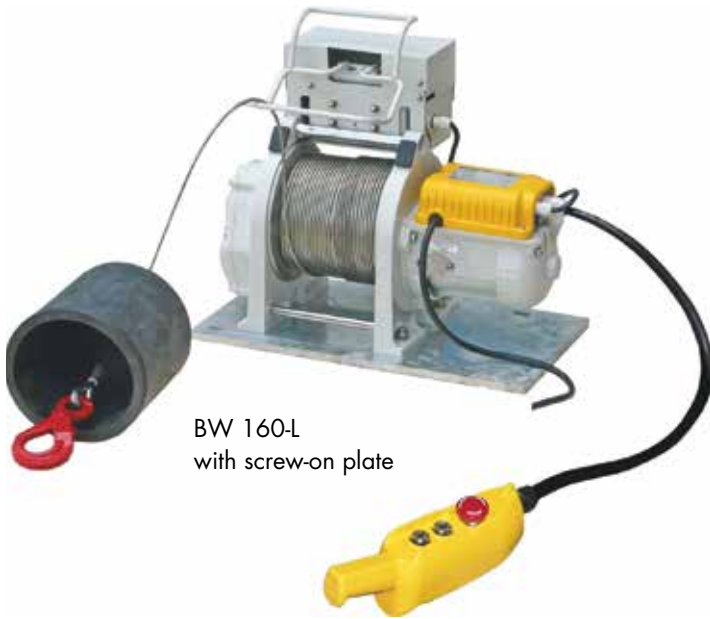

BW 160-L
with screw-on plate

Electric rope winch BW 160-L for wind power plants, construction and trade

The rope winch that is designed especially for wind power plants is designed for long hook paths of up to 100 m and a maximum load bearing capacity of 160 kg at high lifting speeds.

Therefore, heavy loads can be lifted and lowered at high speeds.

The screw-on plate can be used to screw the rope winch tightly to a base, e.g. below the ceiling or on the floor.

Equipment features:

- Operating voltage: 230 V / 50 Hz AC
- Manual control button with UP / DOWN / EMERGENCY STOP as direct control on a 10 m control cable
- Mains connection plug on 5 m cable
- Automatic motor shut-down when the cable is wound up completely
- 100 m steel wire cable, safety hook, additional weight and robust rubber buffer to protect building walls
- Screw-on plate to attach to a foundation

Optional:

- Longer control and mains cable
- Mains isolator

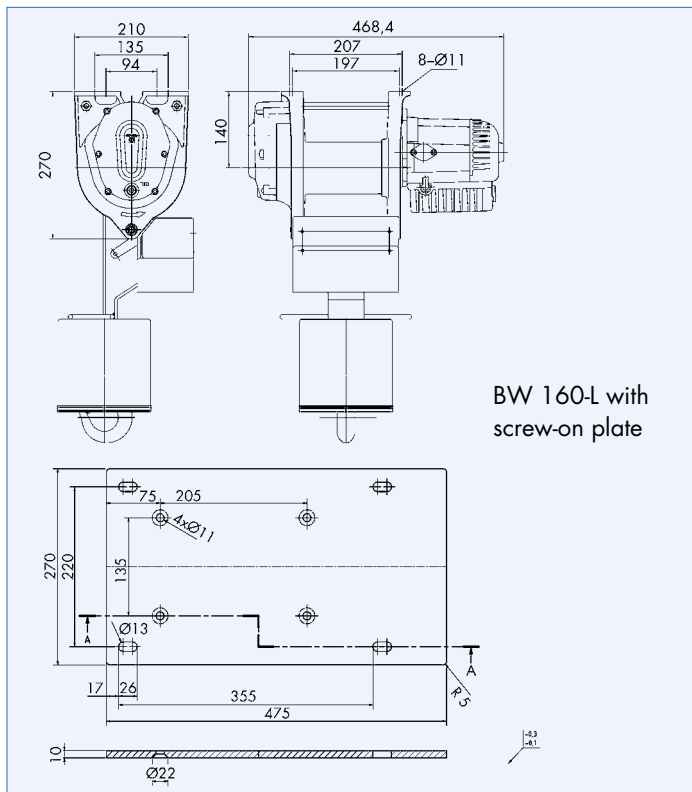

BW 160-L with
screw-on plate

TYPE	BW 160-L with screw-on plate	
Max. capacity in all rope layers	kg	160
Rope speed	m/min	18
Tension	1-Ph / 230 V / 50 Hz	
Motor data	1.5 kW, 40 % ED	
Possible lifting height	m	100
Rope diameter	mm	4.5
Weights complete with wire rope	kg	55
BWL 160-L	Order No.	H30173



Electric rope winch PLANETA – PFW-C

With a load bearing capacity from 250 to 3.000 kg this electrical rope winch with its modular construction principle is one of the most modern devices for pulling, lifting and moving loads. It is approved as a lifting and pulling winch for material transport in accordance with DGUV regulation 54 (D8). With its extensive range of configuration and finishing options it can be adapted to suit almost any installation situation. In standard form, the highly efficient spur gear transmission is equipped with a 3-phase braked motor. The high duty cycle enables operation to continue almost without a break in the most difficult of conditions.



Standard equipment

- Disk brake and spur gear motor
- Grooved drum
- Safety contactor control with low control voltages
- Electric overload protection (over 1.000 kg load capacity)
- Pendant remote control with 3 m cable
- Power supply cable with 3 m cable
- Documentation in German or English
- Test certificate and EC installation declaration

Technical data

- Operating voltage 3 Phases / 400 Volt / 50 Hz or 1 Phases / 230 Volt / 50 Hz (alternating current)
- Duty cycle 60% (reference cycle 10 min.)
- Up to 150 starts per hour
- Protection class: IP55 (jet-water from all sides)
- FEM classification: M3 (1Bm)
(e.g. 10 years one hour daily with medium loads)
- Ambient temperature during operation: -10°C to +40°C

Cable winch controller

Out standard contactor control with control voltage of 42 V combines a lot of security features in a compact housing. By using low control voltage the operator is protected in a case of possible damages like a contact with a broken cable isolation. Generally the control will be delivered with a separate control of the brake. Because of that down sliding of the load will be prevented in a case of emergency stop.

Available at short notice

Other designs

Thanks to the modular construction, for the first time it is possible to retrofit or change many options. This includes loads of 250 – 3,000 kg, multiple cable applications, applications in explosion-proof areas and on ships, or for platforms and studios.



Figure shows optional equipment

Optional equipment

- Lifting- or pulling rope with security hook
- Operational limit switch
- Protective drum cover
- Drum pressure roller
- CE-Label by full equipment

Spindle limit switch

The spindle limit switch is coupled directly to the rope drum and determines the drum's revolutions. You can determine the rope winch's shut-off positions as required by adjusting the switching cam inside the switch. As standard, our spindle limit switches have two contacts, in order to limit the top and bottom hook position for example.

Drum protection

Covering the rope drum prevents objects or items of the operator's clothing entering the rope drive. This reduces the risk of accidents and damage to the winch.

Drum pressure roller

The rope keeps tight on the drum as long as it is under tension. But if it becomes slack, e.g. during shunting applications, when the waggon runs faster than the winch is able to store, a drum pressure roller can help. It presses the rope onto the drum core and maintains it in a tidy condition. The drum pressure roller is also recommended if a free spooling clutch is used.



Made in Germany

The PFW range combines a modern design, innovative technology and superlative components, which are produced exclusively in Germany. Prior to shipping, each winch is tested dynamically with 125% of the nominal load and leaves our factory with a 24 month guarantee.

Basic design

TYPE	PFW-C ...	250	500	1000	2000
Lifting capacity in 1st rope layer to max. hoisting-/pulling distance	kg/m	250/7	500/7	990/6	2,000/5
Lifting capacity in 2nd rope layer to max. hoisting-/pulling distance	kg/m	220/16	440/16	865/16	1,750/14
Lifting capacity in 3rd rope layer to max. hoisting-/pulling distance	kg/m	195/27	390/27	770/26	1,550/24
Lifting capacity in 4th rope layer to max. hoisting-/pulling distance	kg/m	175/38	350/39	695/39	1,400/35
Lifting capacity in 5th rope layer to max. hoisting-/pulling distance	kg/m	160/51	320/52	630/51	1,270/48
Lifting capacity in 6th rope layer to max. hoisting-/pulling distance	kg/m	145/65	295/65	580/65	1,165/61
Lifting capacity in 7th rope layer to max. hoisting-/pulling distance	kg/m	135/81	270/81	535/80	1,075/75
Rope diameter	mm	5	6	8	12
Required rope length remaining on drum	m	1.0	1.2	1.6	2.4
Rope speed 1st rope layer	approx. m/min	8	8	8	8 (4)*
Rope speed 2nd rope layer	approx. m/min	9	9	9	9 (4)*
Rope speed 3rd rope layer	approx. m/min	10	10	10	10 (5)*
Rope speed 4th rope layer	approx. m/min	11	11	11	11 (5)*
Rope speed 5th rope layer	approx. m/min	12	12	12	12 (6)*
Rope speed 6th rope layer	approx. m/min	13	13	13	13 (6)*
Rope speed 7th rope layer	approx. m/min	14	14	14	14 (7)*
Motor power	kW	0.37	0.75	1.5	2.6 (1.5)*
PFW-C with 3PH / 400 V	Order-No.	H62100	H62110	H62130	H62150
PFW-C with 1PH / 230 V (*)	Order-No.	H62109	H62119	H62139	H62159

Options					
Protective drum cover	Order-No.	H62840	H62841	H62843	H62845
Operational limit switch	Order-No.	H62864	H62864	H62865	H62866
Drum pressure roller	Order-No.	H62850	H62851	H62853	H62855
Pulling rope not rotation-resistant with eye hook 8 m *	Order-No.	C62101	C62111	C62131	C62151
Additional pulling rope per m	Order-No.	C05619	C06619	C08619	C12636
Hoisting rope rotation resistant with swivel hook 8 m **	Order-No.	C62102	C62112	C62132	C62152
Additional hoisting rope per m	Order-No.	C05177	C06177	C08177	C12177

Dimensions and weights of the standard designs (Special equipment may vary)

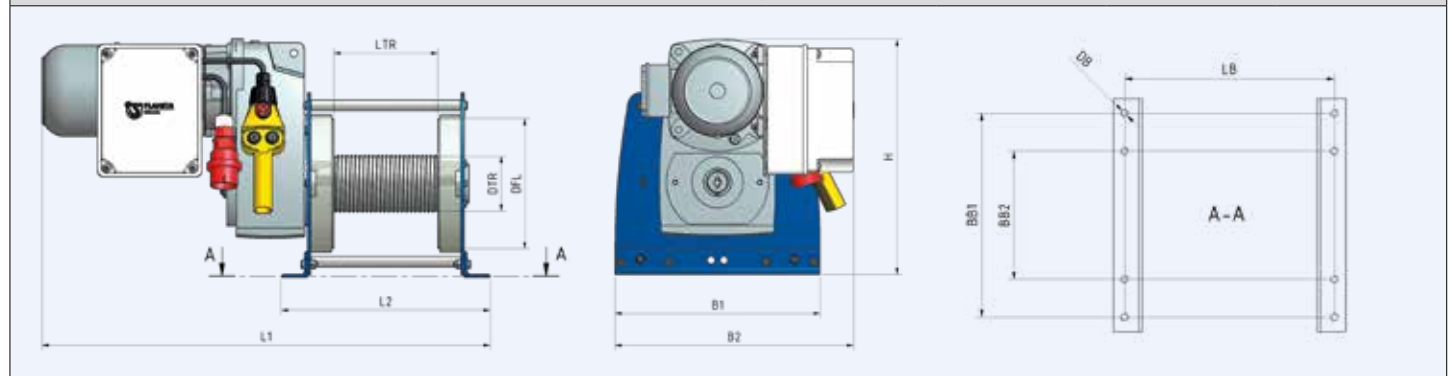

L1	mm	700	770	860	1,000 (1050)*
L2	mm	360	360	400	470
B1	mm	270	320	400	550
B2	mm	380	420	470	550
H	mm	300	335	460	620
LTR	mm	200	200	200	200
DTR	mm	65	80	105	155
DFL	mm	155	190	250	370
LB	mm	330	330	360	420
BB1	mm	220	250	350	500
BB2	mm	-	-	220	320
DB	mm	11	12	12	16
Weight without accessories	approx. kg	40	65	110	240 (250)*

* Rope supplied loose as a coil

More capacities and options on request.

Brake winch BHW

The moderately priced BHW winch is a technical solution to lift and pull loads up to 1.2 tons. The winch has to be fixed with a foot plate by bolts on a solid pedestal. Then the crank can be turned freely in both directions..

Features:

- Zinc plated or yellow stove-enamelling protection (optional)
- Dismountable hand crank
- Automatic load-pressure brake
- Gear and brake in closed housing
- Rope easy to assemble

Winches in stainless steel upon request.



BHW-1200

BHW-1800

BHW-2600

TYPE		BHW-1200	BHW-1800	BHW-2600
Max. pulling force bottom (1st) cable layer	daN	550 / 330*	820 / 660*	1,200 / 960*
Max. pulling force top (9 th) cable layer	daN	200	300	475
Drum diameter	mm	47.8	57.7	75.7
Gearing ratio		4.2:1	5:1	10:1
Lift per crank handle rotation	mm	35	35	25
Lever force	daN	15	22	19
Rope diameter (Construction 2160 N/mm ²)	mm	5	7	8
Standard rope length	m	20	20	18
Plate size L x B	mm	140 x 88	194 x 107	240 x 127
Hole spacing L x B / Ø	mm	95 x 40 / 10	135 x 70 / 10	162 x 77 / 10
A (Dimensions)	mm	156	203	216
B	mm	184	256	293
C	mm	88	107	127
D	mm	210	319	319
E	mm	27	27	27
F	mm	272	283	305
G	mm	51	60	63
H	mm	109	109	109
Weight without rope	kg	3.7	7.7	10.1
BHW... (without rope) galvanized	Order No.	H30024	H30026	H30028
BHW... completd with rope and hook**	Order No.	H30041	H30042	H30043
BHW... (without rope) Stainless steel design	Order No.	H30290	H30291	H30292

* Stainless steel finish
 ** Standard rope lenght



BHW-1200 complete with rope and hook, ready to use.

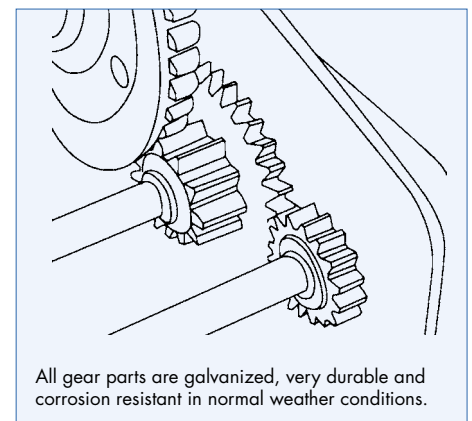
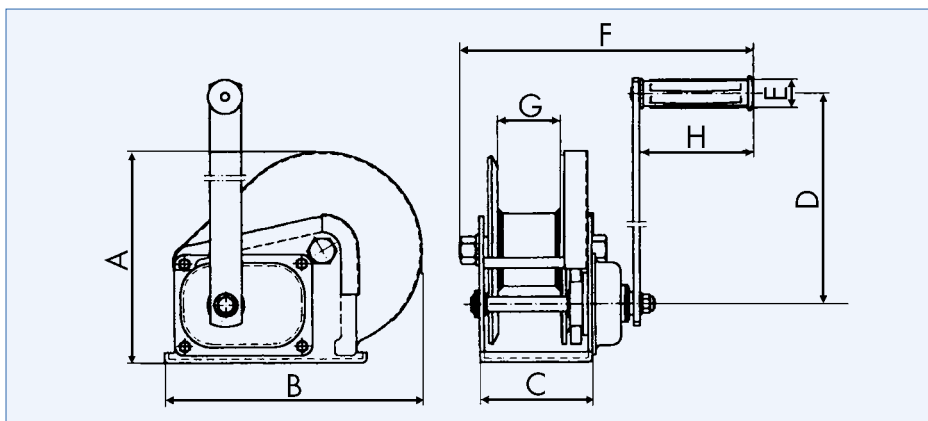

All gear parts are galvanized, very durable and corrosion resistant in normal weather conditions.

Manual rope winches, type AFD

Suitable for use in agriculture, in sewage plants and slurry systems, as well as in cattle and poultry breeding, but also for car trailers.

- Galvanised design
- Open housing for vertical cable guidance
- The gear cover protects the user from injuries
- With load pressure brake
- Integral, robust, galvanised housing
- Optimised gear reduction and improved drum

Manual rope winches, type MR/GM

Drum sprag unit

When the brake is released, the unloaded cable can be pulled off manually.

Two lifting types

Hoist winch, type MR: The crank lever is latched forwards and backwards to rotate the drum, alternatively, also fully cranked.

Hoist winch, type GM: The crank must be turned by 360 degrees, for which the winch must be raised or standing freely in order to enable these rotations.

Equipment features:

- Self-closing load pressure brake
- Drum sprag unit
- All steel design
- Ball bearing with lifetime lubrication
- High-tensile tempered gears
- Fast gear for unloaded cables
- With rotary handle (GM) or ratchet (MR)
- Enamel powder-coated
- Tested with 150 % excess load

TYPE		4 AFD Mini	4 AFD	6 AFD	8 AFD	12 AFD	20 AFD
Max. pulling force bottom (1 st) cable layer	daN	190	340	500	650	900	1,180
Max. pulling force top (9 th) cable layer	daN	80	190	240	270	490	650
Pulling force, rolling load *	daN	350	500	750	900	1,500	2,500
Drum diameter	mm	27	40	45	54	63	76
Rope diameter	mm	3	4	5	6	8	8
Rope length	m	8	12	14	19	13	10
Minimum load for brake function	kg	10	10	10	10	10	10
Gear reduction		1/2.57	1/3.5	1/4.85	1/9.71	1/9.71	1/21.85
Dimensions without hand crank (L x W x H)	mm	126 x 78 x 96	128 x 117 x 96	161 x 132 x 128	200 x 132 x 167	214 x 155 x 170	214 x 155 x 170
Length hand crank	mm	168	170	213	263	267	302
Weight without rope	kg	2.2	2.7	3.7	5.5	7.4	7.8
Manual rope winch AFD without rope	Order no.	H30070	H30071	H30072	H30073	H30074	H30075
Accessories rope with hook	Order no.	H30180	H30181	H30182	H30183	H30184	H30185

* at 30% gradient



4 AFD Mini



4 AFD



8 AFD



20 AFD

Drum sprag unit switching

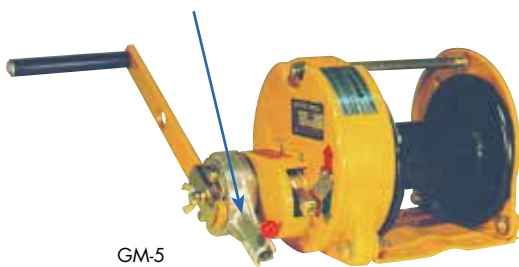

GM-5

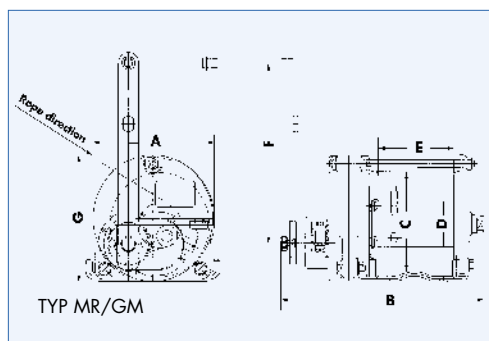

TYP	MR/GM...	-1	-3	-5	-10	-20	-30
Max. capacity	kg	100	300	500	1,000	2,000	3,000
Rope take-up	m	35	32	40	40	45	35
Rope diameter	mm	5	6	6	8	9	12
MR (ratchet lever)							
Lever- 2nd position	daN	16	8.7	8.7	14.8	15	14.2
force 4. Lage	daN	20	12.5	12	17.5	20	20.5
GM (360° lever)							
Lever- 2. Lage	daN	16	8.8	8.7	12.8	15	14.2
force 4. Lage	daN	20	12.5	12	17.5	20	20.5
A (dimensions)	mm	197	212	212	212	280	297
B	mm	282	364	379	414	464	613
C	mm	130	150	175	175	195	195
D	mm	60	60	76	76	89	89
E	mm	120	120	135	170	180	265
F	mm	250	250	250	300	370	370
G	mm	158	210	210	210	250	273
Weight without rope (MR)	kg	9.5	15.5	16.5	17.5	26.5	41.5
Weight without rope (GM)	kg	8	13.5	15	16	25	40
MR... without rope	Order no.	H30009	H30010	H30011	H30012	H30013	H30014
GM... without rope	Order no.	H30015	H30016	H30017	H30018	H30019	H30020
Optional rope with hook	Order no.	H30186	H30187	H30188	H30189	H30190	H30191

Flat webbing slings from polyester

- Manufactured in different colors with type/safety instruction labels
- for gentle load lifting
- Tonnage strips woven in
- Safety factor 7 against breaking
- Safety label with user instructions



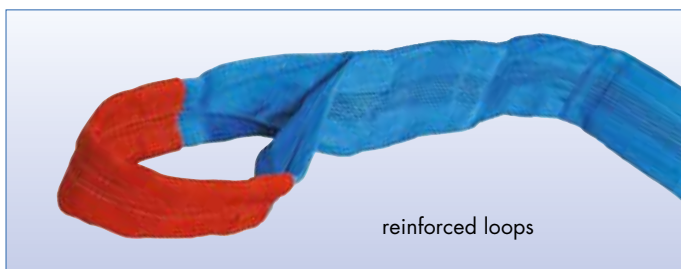

Web slings are manufactured from 25 mm up to 300 mm width (Special sizes up to 900 mm). We offer here our most often requested sizes! They are available for a very competitive price! All slings have a protective PU impregnation and reinforced loops. Textile web slings should be used for applications where other lifting accessories like chains, steel wire or rope could cause damage to the surface of the load. Each sling has a captive, sewn on capacity label and a quality certificate including a tag for your annual safety test report. It also includes a safe use instruction label in two languages as required for product liability.



TYP 1D-240

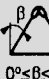

Flat webbing slings from polyester (PES) acc. CEN EN 1492-1 with reinforced loops

TYPE	Capacity WLL (kg) / Safety factor of 7					Band width x tape thickness mm	Order No. for lengths of						
							2 m	3 m	4 m	5 m	6 m	8 m	10 m
double-layer													
1D-30	1,000	800	2,000	1,400	1,000	30 x 7	B00917	B00925	B00933	B00941	B00949	B00957	B00965
1D-60	2,000	1,600	4,000	2,800	2,000	60 x 7	B00918	B00926	B00924	B00942	B00950	B00958	B00966
1D-90	3,000	2,400	6,000	4,200	3,000	90 x 7	B00919	B00927	B00935	B00943	B00951	B00959	B00967
1D-120	4,000	3,200	8,000	5,600	4,000	120 x 7	B00920	B00928	B00936	B00944	B00952	B00960	B00968
1D-150	5,000	4,000	10,000	7,000	5,000	150 x 7	B05002	B05003	B05004	B05005	B05006	B05008	B05010
1D-180	6,000	4,800	12,000	8,400	6,000	180 x 7	-	B00930	B00938	B00946	B00954	B00962	B00970
1D-240	8,000	6,400	16,000	11,200	8,000	240 x 7	-	B00931	B00939	B00947	B00955	B00963	B00971

- **Special versions and further designs on request!**
- **PUR coatings and PUR protective sleeves on request!**



Round slings

PLANETA

Round slings from polyester

- With PU impregnated, abrasion-proof protection coat
- Colour code acc. European CEN-standard
- With stamped-in capacity and tonnage stripes
- Safety factor 7 against breaking
- Safety label with user instructions

Major advantage:
DOUBLE PROTECTIVE SLEEVE
 - Extremely gentle on suspended loads
 - Extremely flexible
 - Extremely good value for money
 - Extremely light

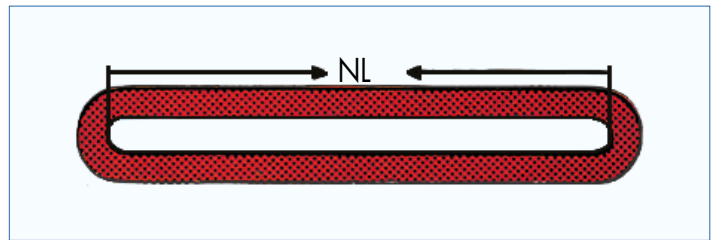
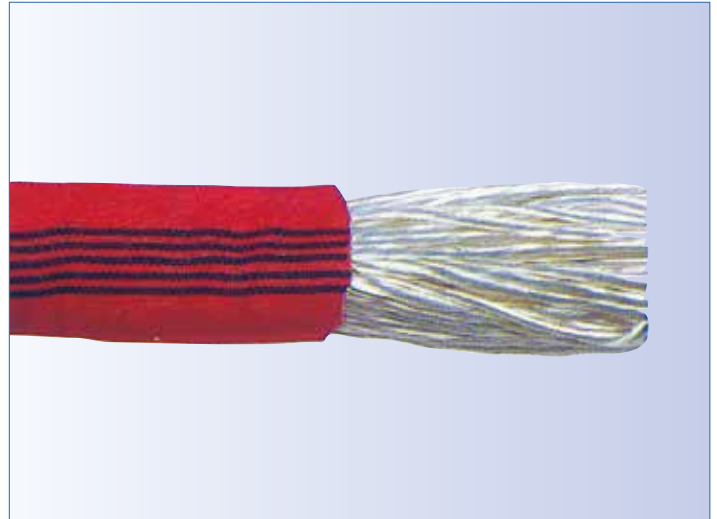
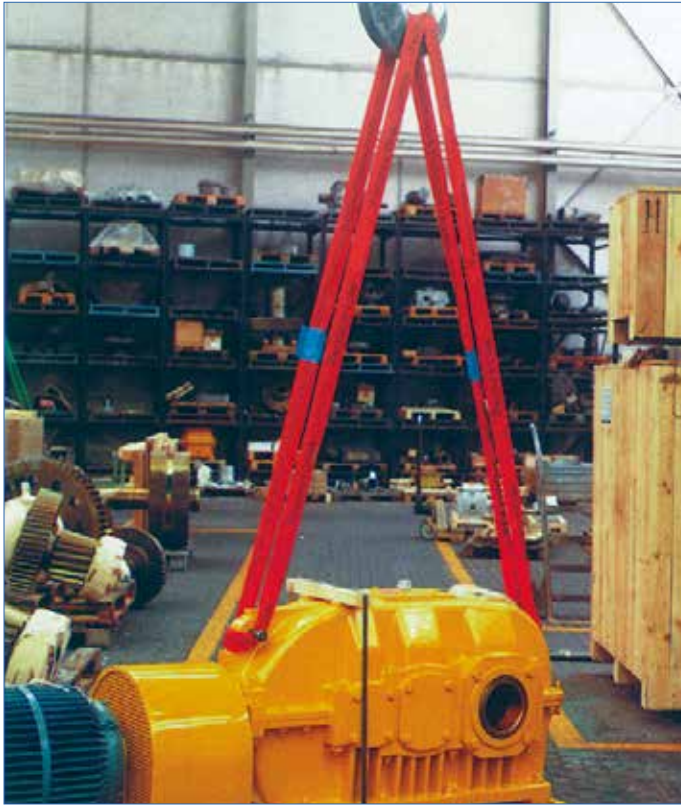

Round slings from polyester (PES) acc. CEN EN 1492-2

TYPE	Capacity WLL (kg) / Safety factor of 7					Order No. with usable length (NL = L1)						
						1 m	1.5 m	2 m	2.5 m	3 m	4 m	5 m
KS01	1,000	800	2,000	1,400	1,000	B00102	B00103	B00104	B00105	B00106	B00108	B00110
KS02	2,000	1,600	4,000	2,800	2,000	B00202	B00203	B00204	B00205	B00206	B00208	B00210
KS03	3,000	2,400	6,000	4,200	3,000	B00302	B00303	B00304	B00305	B00306	B00308	B00310
KS04	4,000	3,200	8,000	5,600	4,000	B00402	B00403	B00404	B00405	B00406	B00408	B00410
KS05	5,000	4,000	10,000	7,000	5,000	B00502	B00503	B00504	B00505	B00506	B00508	B00510
KS06	6,000	4,800	12,000	8,400	6,000	B00602	B00603	B00604	B00605	B00606	B00608	B00610
KS08	8,000	6,400	16,000	11,200	8,000	-	B00803	B00804	B00805	B00806	B00808	B00810
KS10	10,000	8,000	20,000	14,000	10,000	-	B00830	B00831	B00832	B00833	B00835	B00837

- Special versions and further designs on request!
- PUR coatings and PUR protective sleeves on request!



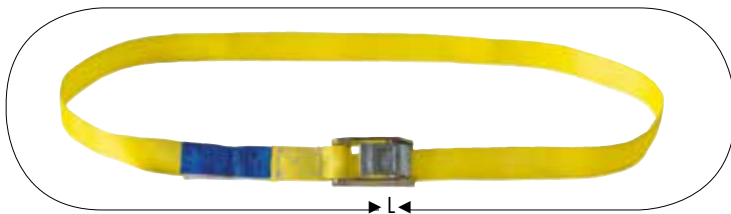

Cambuckle tie down Type KG 250 and Type KG 500

Band width: 25 mm, Ratchet lashing, 4 m or 6 m complete



TYPE	Capacity daN	Order No.	
		complete L = 4 m	complete L = 6 m
KG 250 N	250	E00011	-
KG 500 N	500	E00013	E00022

LC in direct hoist	LC in the hooping
 endless	 endless
250 daN	500 daN



Longer lengths on request!

Ratchet lashing Type RG 500

Band width: 25 mm, Fixed end 0.4 m, Loose end 3.6 m Ratchet lashing, 4 m or 6 m complete



TYPE	Hook type / Final fittings	Order No.	
		complete L = 4 m	complete L = 6 m
RG 500 A	Type A, Double wire J hook	E00030	E00035
RG 500 N	Endless (without hook)	E00033	E00036

LC in direct hoist	LC in the hooping
 two-piece	 endless
250 daN	500 daN

Longer lengths on request!



Ratchet lashing 35 mm and 50 mm

PLANETA

Hook types:



Type A
Double wire J hook



Type C
Claw hook



Type D
Snap hook

PUR edge protection plates 35 mm + 50 mm on request!

Ratchet lashing Type RG 2000

Band width: 35 mm, fixed end 0.4 m, loose end 5.6 m ratchet lashing, 6 m complete

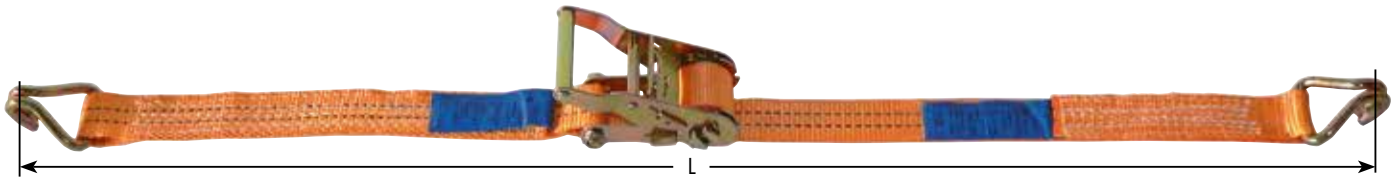

TYPE	Hook type / Final fittings	Order No.
	two-piece Ratchet lashing hooks	complete L = 6 m
RG 2000 A	Type A, Double wire J hook	E00050
RG 2000 N	Endless (without hook)	E00053

LC in direct hoist	LC in the hooping	STF
two-piece	endless	
1,000 daN	2,000 daN	150 daN

Ratchet lashing Type RG 4000

Band width: 50 mm, fixed end 0.4 m, loose end 7.6 m ratchet lashing, 8 m complete

Ratchet lashing, 8 m complete

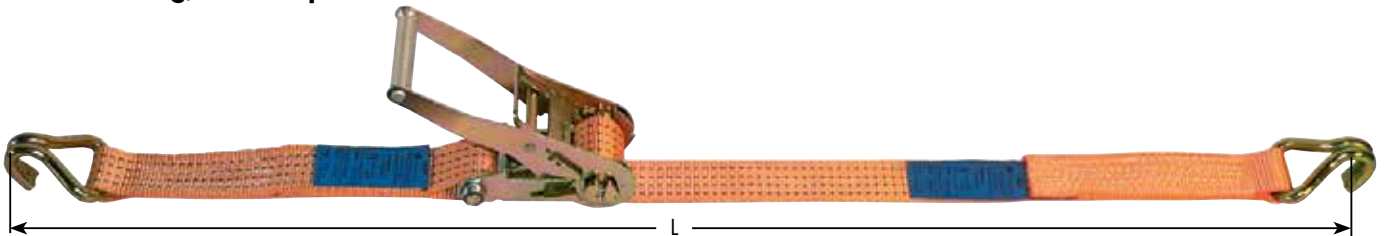

TYPE	Hook type / Final fittings	Order No.
	two-piece Ratchet lashing hooks	complete L = 8 m
RG 4000 A	Type A, Double wire J hook	E01001
RG 4000 C	Type C, Claw hook	E01002
RG 4000 D	Type D, Snap hook	E01004
RG 4000 N	Endless (without hook)	E01011

LC in direct hoist	LC in the hooping	STF
two-piece	endless	
2,000 daN	4,000 daN	250 daN



Longer lengths on request!

Ratchet lashing Type RG 5000

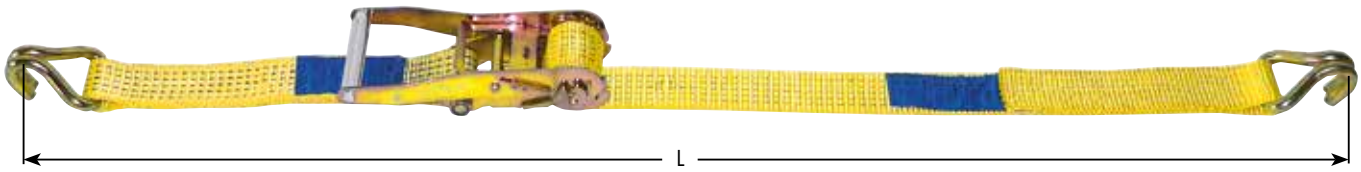
Band width: 50 mm, Fixed end 0.4 m, Loose end 7.6 m, Ratchet lashing, 8 m complete



TYPE	Hook type / Final fittings	Order No.
	two-piece Ratchet lashing hooks	complete L = 8 m
RG 5000 A	Type A, Double wire J hook	E01020
RG 5000 C	U profile hook C	E01021
RG 5000 D	Carabiner D	E01023
RG 5000 N	Securing strap, one piece (without hook)	E01030

LC in direct hoist	LC in the hooping	STF
 two-piece	 endless	
2,500 daN	5,000 daN	250 daN



Longer lengths on request!

Securing strap with long lever ratchet Type RGL 5000

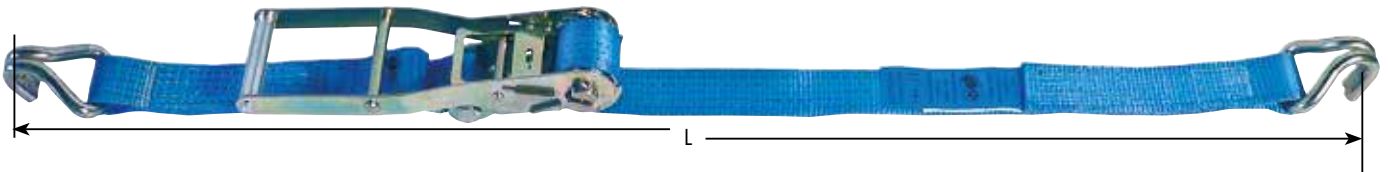
Band width: 50 mm, Fixed end 0.4 m, Loose end 7.6 m Ratchet lashing, 8 m complete (L)



TYPE	Hook type / Final fittings	Order No.
	two-piece Ratchet lashing hooks	complete L = 8 m
RGL 5000 A	Type A, Double wire J hook	E01033

LC in direct hoist	LC in the hooping	STF
 two-piece	 endless	
2,500 daN	5,000 daN	500 daN

Longer lengths on request!





Vertical plate clamp SLC

With hinged support ring to enable metal sheets and steel plates to be lifted, turned and transported in all directions.

With a little more freedom! Produced from tempered steel. Suitable for surfaces up to a hardness of 35 HRC.

Observe load reduction depending on working angle!

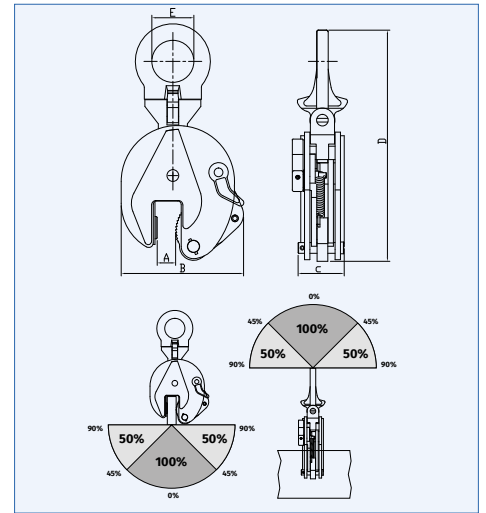

TYPE	Capacity kg	Grip range mm	Dimensions mm					Weight approx. kg	Order No.
			A	B	C	D	E		
SLC-0.5	500	0 – 15	15	103	36	212	30	2.0	F00050
SLC-1	1,000	0 – 20	20	145	60	290	50	4.0	F00051
SLC-2	2,000	0 – 25	25	175	65	375	68	8.0	F00052
SLC-3	3,000	0 – 30	30	232	90	425	75	15.0	F00053
SLC-5	5,000	0 – 50	50	215	102	480	68	21.0	F00054



Vertical plate clamp VLC

The standard lifting clamp to lift sheet steel vertically and turn it. The sheet gripper has a safety lock.

Fast clamp opening thanks to practical grip ring. Very robust design!

Produced from tempered steel. Suitable for surfaces up to a hardness of 35 HRC.

Observe load reduction depending on working angle!

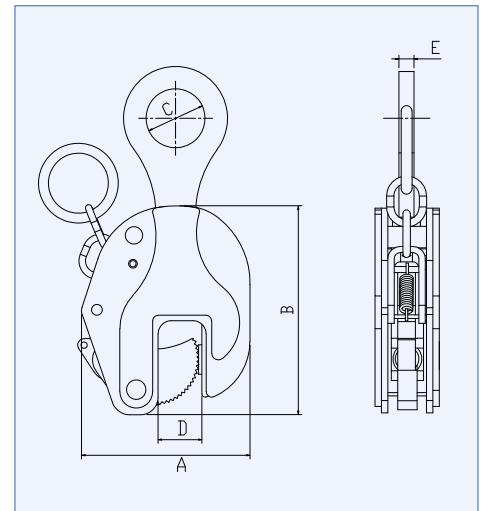

TYPE	Capacity kg	Grip range mm	Dimensions mm					Weight approx. kg	Order No.
			A	B	C	D	E		
VLC-1	1,000	0 – 22	124	158	50	30	14	3.6	F00001
VLC-2	2,000	0 – 30	154	190	54	40	16	5.5	F00002
VLC-3	3,000	0 – 40	180	230	60	50	18	10.0	F00003
VLC-5	5,000	0 – 50	222	283	68	62	18	17.0	F00004
VLC-8	8,000	0 – 60	265	310	65	71	22	26.0	F00008



Horizontal plate clamp HPC-2

Standard sheet metal lifting clamp for the horizontal transportation of individual sheets through use in pairs as a minimum.

Produced from tempered steel. Suitable for surfaces up to a hardness of 35 HRC.

Observe load reduction depending on working angle!

Set consisting of 2 pieces.

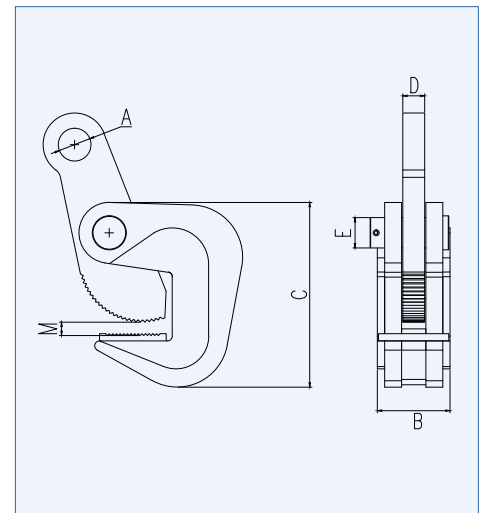

TYPE	Capacity (per pair) kg	Grip range mm	Dimensions mm					Weight approx. kg	Order No.
			A	B	C	D	E		
HPC-2-1	1,000	0 – 30	25	54	140	14	22	4.0	F00935
HPC-2-2	2,000	0 – 50	27	62	164	18	25	5.7	F00936
HPC-2-3	3,000	5 – 60	30	69	193	20	27	7.6	F00937
HPC-2-5	5,000	10 – 80	37	73	233	22	28	11.5	F00938
HPC-2-6	6,000	10 – 100	37	81	280	22	30	14.5	F00939

Horizontal plate clamp HPC-4

Sheet metal lifting clamp for transporting support profiles or individual metal sheets horizontally and turning these to vertical. Locking through spring pre-tensioning.

Simple opening through lifting mechanism with grip ring. Produced from tempered steel.

Suitable for surfaces up to a hardness of 35 HRC.

Set consisting of 2 pieces.

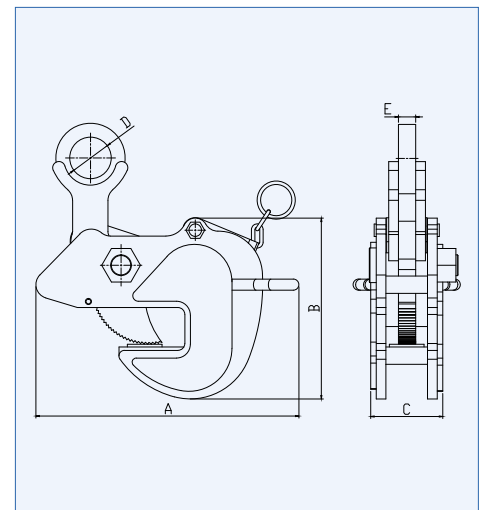

TYPE	Capacity (per pair) kg	Grip range mm	Dimensions mm					Weight approx. kg	Order No.
			A	B	C	D	E		
HPC-4-0.5	500	0 – 25	235	122	54	44	16	3.2	F00944
HPC-4-1	1,000	0 – 25	262	155	60	50	16	5.3	F00945
HPC-4-2	2,000	0 – 30	280	177	72	56	18	7.9	F00946
HPC-4-3	3,000	0 – 38	315	209	88	58	22	10.5	F00947
HPC-4-5	5,000	0 – 40	380	261	104	60	28	27.6	F00948



Horizontal plate clamp MPC

Lifting clamp for sheet steel packages or multiple positively locked sheets lying on top of each other, with use in pairs as a minimum.

Simple adjustment to the required sheet package thickness through height adjustment of the gripper.

Produced from tempered steel. Suitable for surfaces up to a hardness of 35 HRC.

Observe load reduction depending on working angle.

Set consisting of 2 pieces.

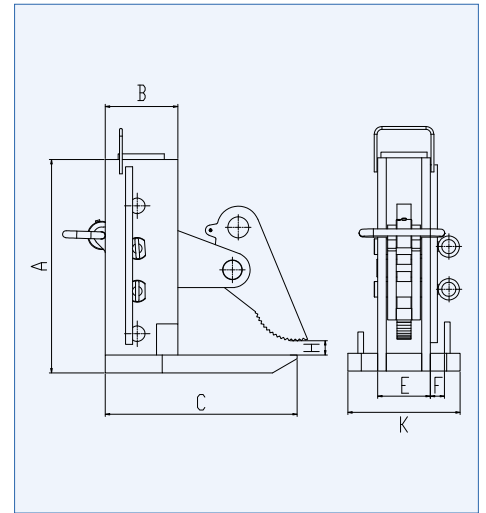

TYPE	Capacity (per pair) kg	Grip range mm	Dimensions mm						Weight approx. kg	Order No.
			A	B	C	D	E	F		
MPC-3	3,000	0 – 180	300	102	270	74	20	158	19.0	F00950
MPC-4.5	4,500	0 – 240	420	120	280	74	24	158	26.0	F00951
MPC-6	6,000	0 – 240	450	123	300	88	28	175	40.0	F00952
MPC-8	8,000	0 – 240	515	128	310	92	30	200	51.0	F00953



Round stock grabs RTG

Lifting gripper for components with round profiles. Suitable for many materials, e.g. steel, concrete, wood, etc.

Easy to apply to the component through possibility of locking in the open position.

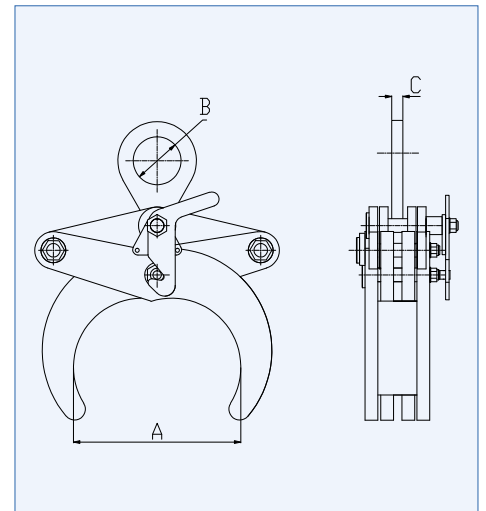

TYPE	Capacity kg	Grip range mm	Dimensions mm			Weight approx. kg	Order No.
			A	B	C		
RTG-0.5	500	50 – 100	100	40	12	3.2	F00963
RTG-1	1,000	50 – 100	100	50	14	4.1	F00964
RTG-2	2,000	80 – 130	130	55	16	16.0	F00965
RTG-3	3,000	120 – 220	220	60	18	32.0	F00966
RTG-5	5,000	200 – 320	320	60	18	104.0	F00967



Rail clamp RG

Profile lifting clamp for rails or support profiles.

Easy to use due to automatic spring-loaded locking in the open position.

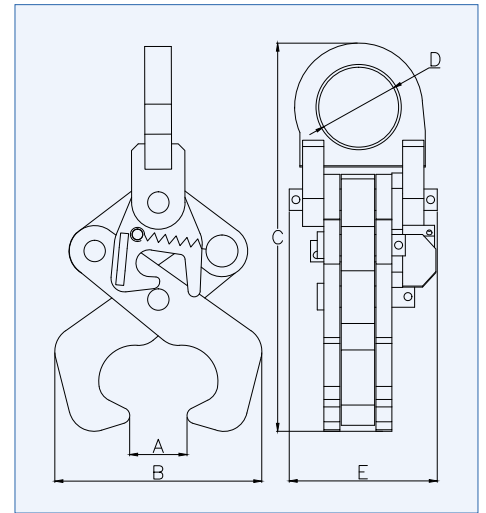

TYPE	Capacity kg	Grip range A mm	Dimensions mm				Weight approx. kg	Order No.
			B	C	D	E		
RG-2	1,000	15 – 85	170	302	60	111	6.2	F00969



Pipe plate clamp PPC

Lifting clamp for the horizontal transportation of tubular profiles.

Suitable for diverse materials.

Gentle transport of materials due to protective plastic coating on the contact surfaces.

Intended exclusively for use in pairs.

Set consisting of 2 pieces.

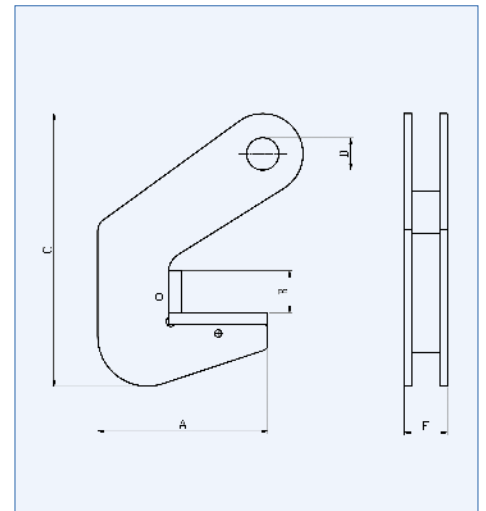

TYPE	Capacity (per pair) kg	Grip range mm	Dimensions mm				Weight approx. kg	Order No.
			B	C	D	E		
PPC-1.5	1,500	40	127	220	27	35	1.5	F00955
PPC-3	3,000	40	142	228	27	35	2.0	F00956
PPC-4	4,000	50	144	228	30	40	2.8	F00957
PPC-6	6,000	50	152	232	30	40	3.2	F00958
PPC-8	8,000	70	155	260	30	42	3.6	F00959



Barrel clamp DLC

Barrel lifting clamp for the vertical transportation of barrels with standard dimensions.

Automatic and easy to use due to simple application on the upright barrel.

Locks with lifting.

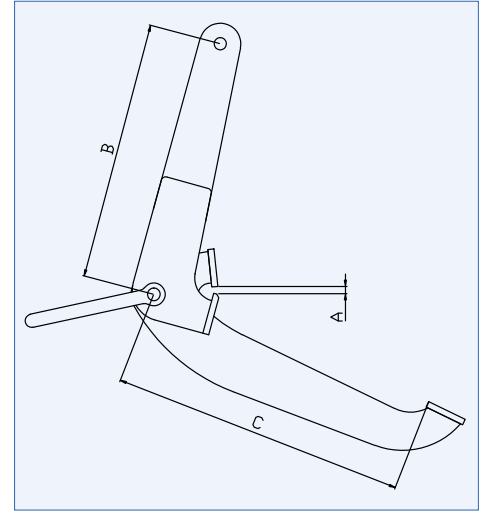

TYPE	Capacity kg	Grip range mm	Dimensions mm		Weight approx. kg	Order No.
			B	C		
DLC 0.6	600	0 - 30	310	385	5.0	F00970



Barrel clamp DL

Barrel clamps for the vertical transportation of barrels. Suitable for numerous applications.

For lifting barrels with different dimensions and shapes, with or without lid. One-handed operation possible, observe load-bearing capacity!

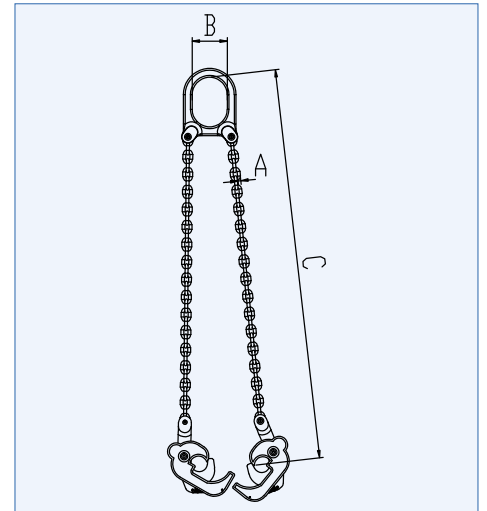

TYPE	Capacity kg	Grip range mm	Dimensions mm		Weight approx. kg	Order No.
			B	C		
DLC 0.5 DLC 1	500* 1,000**	0 - 30	310	385	5.0	F00968

*) 1 string **) 2 strings combined



The latest generation of lifting equipment

Compact – light – powerful

Special features

Ideal for integrating into machine tools, steel structures, cutting torch systems, shipyards, foundries and steel works for moving injection moulding tools and punching tools and for general requirements in modern industrial companies.

- Easy to handle
- Absolute reliability
- Robust design
- Extremely safe
- Competitively priced
- Small external dimensions
- Low weight
- High power
- Total operational safety

Custom-made products for vertical transportation of metal sheets on request!

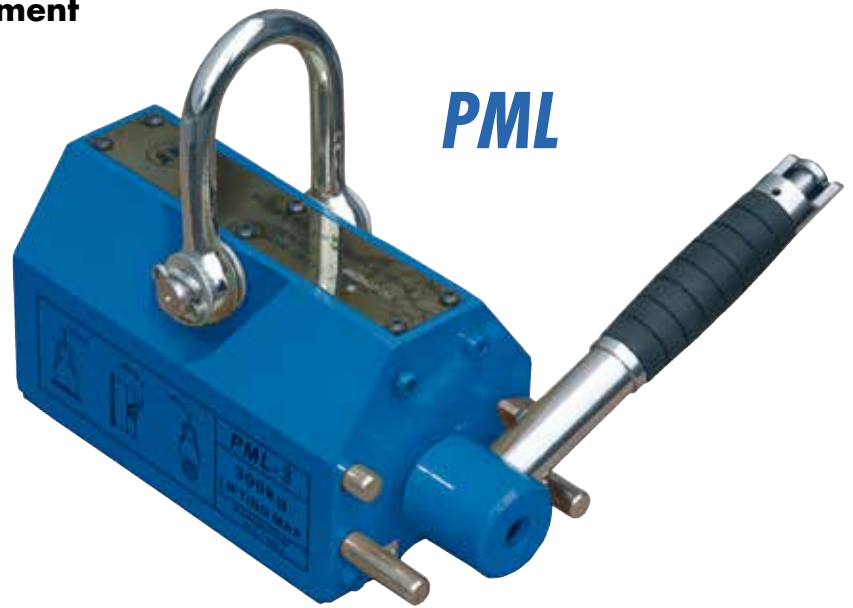

PML



Activate and deactivate the PML magnet with a single operating movement



Simply reversing the lever activates the magnet on the magnetic base. A safety device locks the lever in the MAG phase in order to prevent any unwanted demagnetisation (DEMAG).

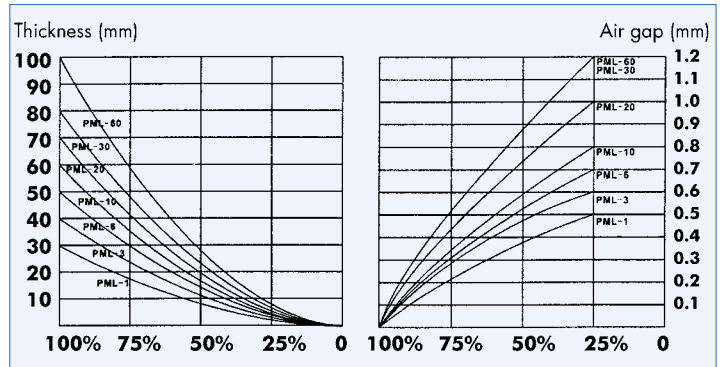
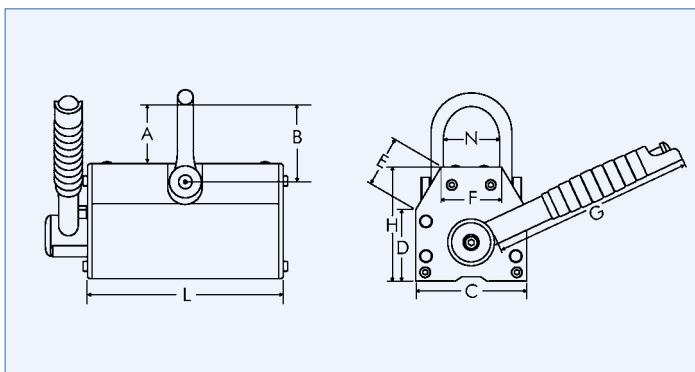

TYPE	Capacity kg	Dimensions in mm										Flat material			Round material			Weight kg	Order No.
		A	B	C	D	E	F	G	H	L	N	max. load kg	min. thickness mm	max. length mm	max. load kg	min./max. diameter mm	max. length mm		
PML-1	100	42	145	72	44	28	28	116	76	94	31	100	15	1,500	45	max. 50	1,000	3	F00060
PML-3	300	59	180	94	59	39	44	142	106	169	46	300	25	2,000	180	max. 100	1,750	11	F00061
PML-6	600	87	230	115	70	44	56	178	115	218	58	600	30	2,250	270	max. 125	2,000	25	F00062
PML-10	1,000	110	280	145	100	68	88	237	147	270	95	1,000	40	2,500	450	max. 150	2,500	42	F00063
PML-20	2,000	150	450	160	135	98	115	397	165	340	117	2,000	55	3,000	900	max. 200	3,000	70	F00064



PLANETA

A3-WH stamp lifter

Thigh high quality hydraulic cylinder has a large base plate to ensure that it is stable. The pump rocker lever is easy to move and is driven by a 2-part lever with clearance for valve control.

The stamping plate is corrugated and can also be unscrewed using the thread. The A3-WH is a reliable aid in the workshop and as a vehicle accessory. Protected against overloading by an overpressure valve!

TYPE	Load bearing capacity kg	Lifting height mm	Additional unscrewable height mm	Min./ max. construction height mm	Base plate width mm	Base plate length mm	Piston diameter mm	Empty weight kg	Order No.
A3-WH2	2,000	90	50	158 – 298	93	95	23	2.2	K00001
A3-WH3	3,000	100	50	168 – 318	93	95	23	2.3	K00002
A3-WH5	5,000	125	60	195 – 380	100	105	27	3.3	K00003
A3-WH8	8,000	125	60	200 – 385	118	110	38	5	K00004
A3-WH12	12,000	125	60	215 – 400	137	133	43	6.7	K00005
A3-WH15	15,000	140	60	225 – 425	142	135	48	7.7	K00006
A3-WH20	20,000	145	60	235 – 440	162	153	48	10	K00007
A3-WH32	32,000	150	–	255 – 405	170	173	56	13	K00008
A3-WH50	50,000	180	–	285 – 465	150	188	71	21	K00009



Machine hoist, type HM

This hydraulic hoist is particularly well suited to repair and maintenance work and to the installation of heavy machines. The installation position is irrelevant here. The housing can be rotated through 360 degrees and the lowering speed has precision adjustment.

The integrated pressure-relief valve protects the hydraulic system against overloads. If needed, the hand lever can be removed.

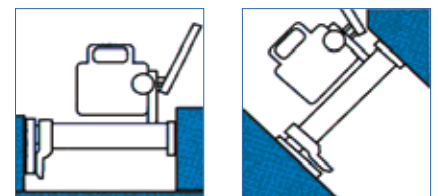
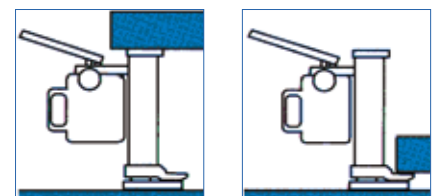
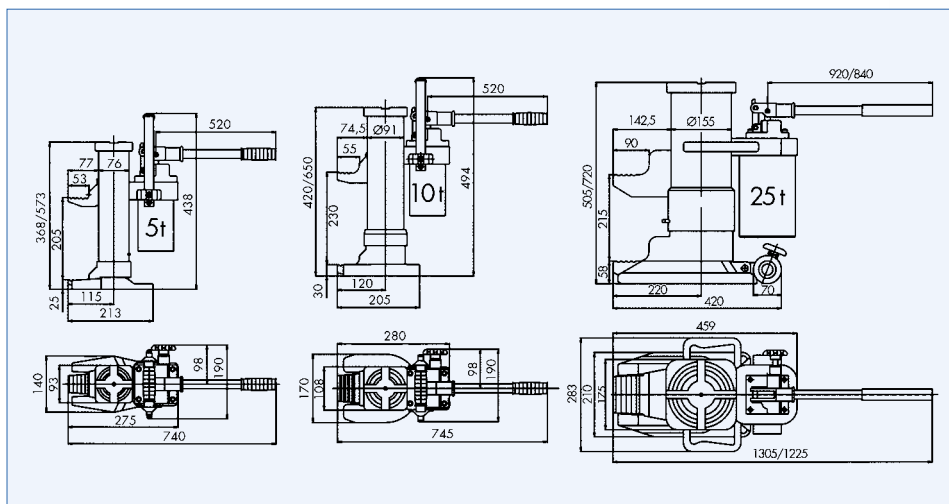

TYPE	Capacity kg	Claw lifting height mm	Lifting height for the head mm	Min./Max. Leverage kg	Weight kg	Order No.
HM 5	5,000	25 – 230	368 – 573	38	25	K00021
HM 10	10,000	30 – 260	420 – 650	40	35	K00022
HM 25	25,000	58 – 273	505 – 720	40	102	K00023

Rack drives or steel winches per DIN 7355 are rack drives with a lifting housing

The special benefits:

- Rack and transmission protected as well as possible.
- With spur gear transmission, i. e. high efficiency.
The transmission is easy to access.
- Transmission components made of high-grade steel, hardened or tempered.
- Quality features in accordance with the specification sheet from the FEM (Federation Européenne de la Manutention).
- Produced in accordance with the provisions of accident prevention regulations and the stipulations of the trade association.

Safety crank:

All winches on this page are equipped with a safety crank in accordance with the accident prevention regulations – with automatic load pressure brake – holds the load in the required position.

Ratchet crank:

All winches on this page can be supplied with a ratchet crank on request. This enables the winches to be activated even in confined spaces.

DIN-Steel Jack Type SK

with lifting body (DIN standard) and foldable safety crank SIKU

DIN-mechanical steel jacks are used to lift loads like machines or trucks. The hand crank is operated by manual power. They can be used anywhere as long the claw fits under a load. The housings climbs up along a rack and is held in any position by a safety brake when cranking stops. SIKU means non-detachable safety crank for 360 degree turning operation.

TYPE	Capacity kg	Bauhöhe mm	Hubhöhe mm	Klauenhöhe mm	Weight ca. kg	Order No. with SIKU
SK-1.5	1,500	725	360	67	17	K00010
SK-3	3,000	725	375	72	22	K00011
SK-5	5,000	725	350	80	29	K00012
SK-10	10,000	800	300	90	41.5	K00013
SK-20	20,000	800	340	95	60	K00015



SK

DIN-Steel Jack Type VSK

Lifting claw with multiple height settings and SIKU safety crank

The VSK is suitable for lifting, pushing, moving and bracing loads. However, it can also be used to press down or straighten up components. The large base plate provides a secure platform for this. The claw attachment has 9 different settings. Compact design – easy to operate.

TYPE	Tragfähigkeit kg	Bauhöhe mm	Hubhöhe mm	Klauenhöhe mm	Gewicht ca. kg	Order No. with SIKU
VSK-3	3,000	725	380	74	26	K00017
VSK-5	5,000	720	300	64	34.5	K00018



VSK

Ratchet crank Type RAKU

TYPE	For steel winches with load bearing capacities kg	Order No.
RAKU 1.5	1,500	K00025
RAKU 3-5	3,000 – 5,000	K00026
SK-5	10,000	K00027

Upon request:

- Lock winches
- Rail hoist winches
- Stainless steel rack drives
- Special designs



RAKU



A series of horizontal dotted lines for writing notes.

A series of horizontal dotted lines for writing, spanning the width of the page.



PLANETA



PLANETA - Hebetchnik GmbH

Resser Straße 17
44653 Herne
Germany

Phone: +49 (0) 2325 9580 0
Fax: +49 (0) 2325 77077

E-Mail: info@planeta-hebetechnik.de
Internet: www.planeta-hebetechnik.de

