



GMV A/S - V7

**Battery powered transport trolley
for flexible transport and handling
of heavy loads in the construction
and general industry.**

 **GMV**
Cranes and Handling



What is an ErgoMover?

Ergonomic and efficient handling of plasterboards and other building materials

ErgoMover is the original electric transport trolley that is designed to cope with the heavy loads on site.

The ErgoMover is designed to transport and handle full stacks of plasterboards and to transport all other building materials in areas where it is not possible to use a forklift truck or other machines equipped with forks.

THE ERGOMOVER COMES IN THREE DIFFERENT OVERALL MODELS:

- **ERGOMOVER GO** - without hydraulic lift of the platform.
- **ERGOMOVER LIFT & GO** - with hydraulic lift of the platform.
- **ERGOMOVER MANIPULATOR** - with hydraulic lift and 90° tilt of the platform.

As the only electrical transport trolley on the market, ErgoMover is available in many different configurations - depending on your specific need.

E.g. ErgoMover Go and ErgoMover Lift & Go are available in versions for ground protection mats, with a rotatable platform and with radio remote control of the trolley.

ErgoMover can be used to transport a whole range of different types of load.

Here are a few examples:

PLASTERBOARDS
FLOOR TILES
GRANITE
PALLETS
STEEL PIPE
STEEL PROFILES

GROUND PROTECTION MATS
DOORS
STONE
SCAFFOLDING
BUILDING MATERIALS
AND MUCH MORE...

ErgoMover features



EMERGENCY STOP

Emergency stop on the drawbar. Stops immediately when activated.

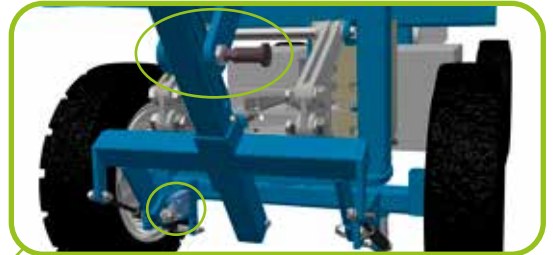

Arm lock and safety switch

- Lock of arm in vertical position when the trolley is not used.
- Safety switch on the drawbar, which protects against accidental driving with the trolley.



Fork pockets and lifting eye

Lifting eye and fork pockets for lifting with a forklift.

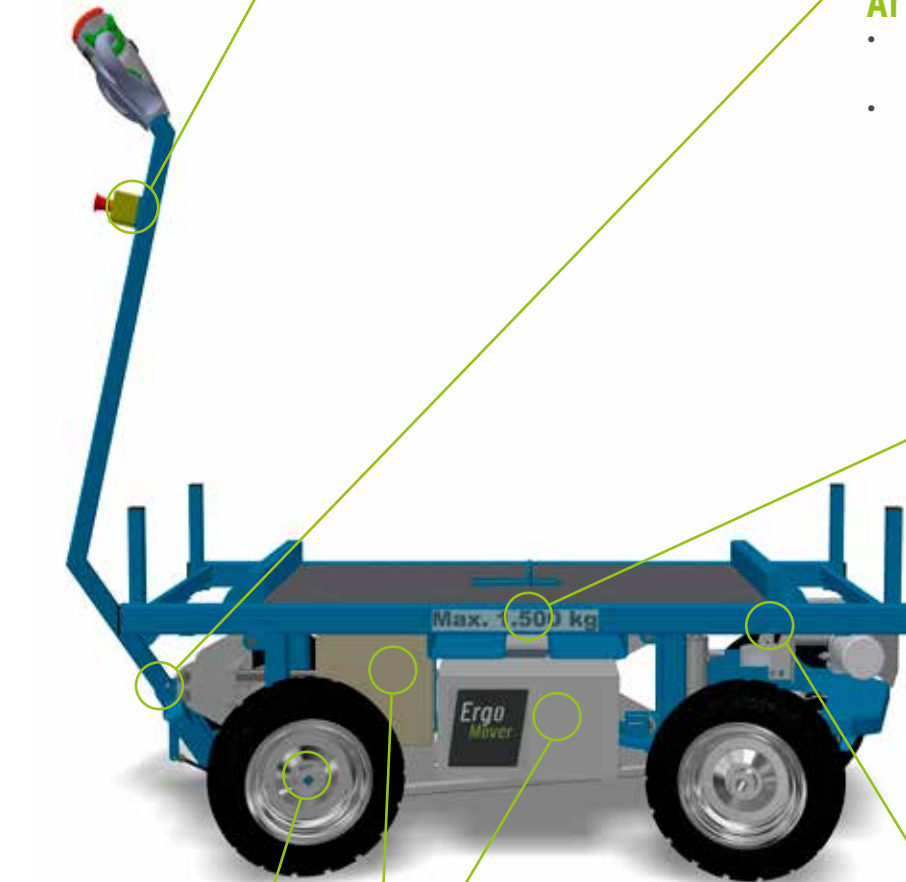

Electric propulsion

- Great traction.
- 4-wheel steering (front and rear axle turn simultaneously).
- Easy access to fuses in closed cabinet.
- Maintenance-free AGM battery with long operating time.



Lashing eyes

Lashing eyes on each side of the trolley for lashing down cargo.

Why should you invest in an ErgoMover?



Many manual transport trolleys available in the market are cheap to purchase, but expensive to operate, as moving the trolley with a load requires a lot of labour.



Often you forget that the labour cost can be quite substantial, when buying manual transport trolleys. The increased wear on back, shoulders and legs can lead to sick leaves, which is another hidden factor.



Investing in an ErgoMover battery powered transport trolley enables a single operator to handle heavy loads up to 1.500 kg. without physical effort – a significant saving in labour cost!



With the ErgoMover you eliminate any strain on back, shoulders and legs, as the trolley's electric motor drives the trolley forward!



ErgoMover Wireless

On the ErgoMover Wireless versions we have removed the drawbar and replaced it with either a radio remote control or a cable remote control. This provides more options for load length and significantly limits the turning radius.

All control of the driving and hydraulic functions are done via the radio control.

LARGE CAPACITY

Whichever model you choose, ErgoMover Wireless can easily transport long loads such as steel pipes and steel profiles of up to 1.500 kg.

WHICH ERGOMOVER MODELS ARE AVAILABLE AS WIRELESS?

All our ErgoMover Go and ErgoMover Lift & Go models are available as Wireless with radio control. See the individual models for further specifications.





OPTION: Extension, suitable for transport of long loads.

ErgoMover Go

A powerful transport trolley without hydraulic functions for applications that only require transport of materials. Equipped with all-terrain electric motor and 4-wheelsteering, the trolley is ideal for construction sites.

DIFFERENT MODELS

The ErgoMover Go is available with several different types of standard flat beds, for example with bearers so that non-palletized goods can be set down on it from a truck-mounted crane.

Other options are a flat bed with lashing eyelets which makes it ideal, for example, for lashing racks, so that glass panels can be transported through narrow passages.



ErgoMover Go

SPECIFICATIONS*

Lifting capacity:	1.500 kg
Transport of plates of up to:	3.000 mm
Length, table:	1.620 mm
Width, table:	698 mm
Total width :	701 mm
Total length w. handle down:	3.021 mm
Total length Wireless:	1.702 mm
Height:	575 mm
Weight, w. drawbar:	290 kg
Weight, Wireless	297 kg
Turning radius	~ 3,5 m
Voltage:	24 Volt
Speed:	0-6 km/h

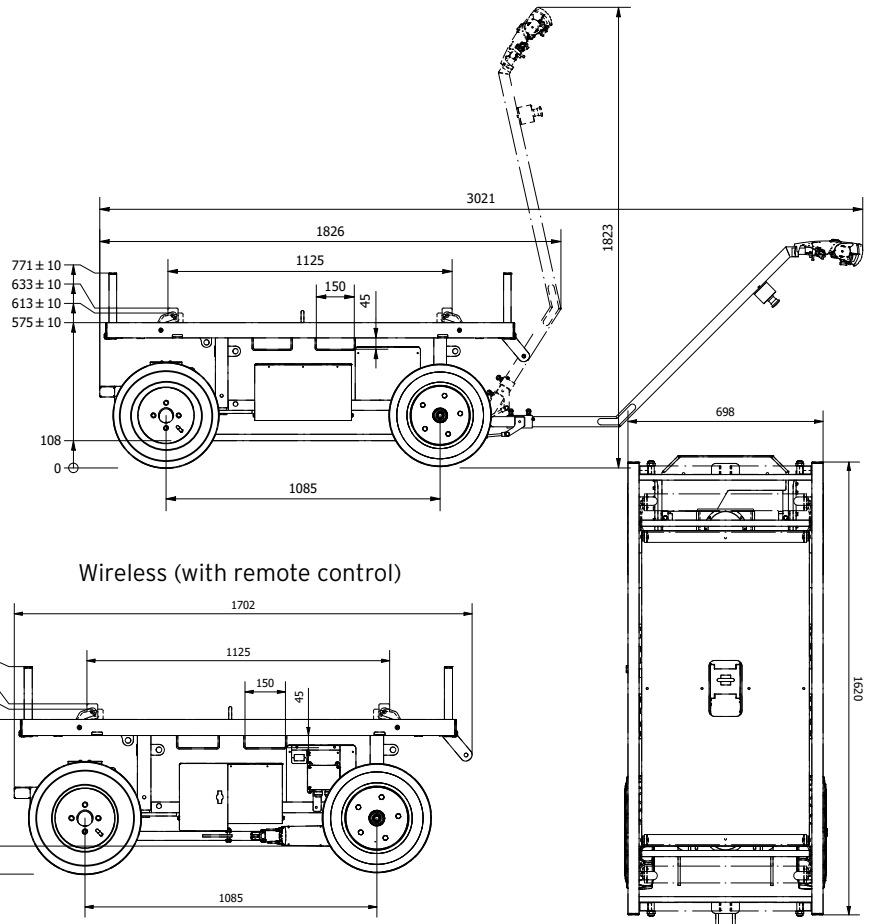
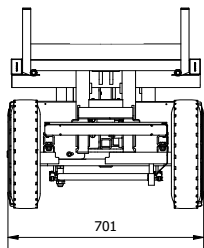

*The dimensions are indicative and may vary +/- 10mm

UNIQUE USABILITY AND SAFETY

The ErgoMover Go is equipped with an ergonomic and user-friendly handle with built-in safety functions which lives up to the strictest safety norms. The belly button makes sure the operator is not caught between machine and the wall. Safety device will bring the machine to a complete stop when you let go of the handle. The ErgoMover Go is also equipped with a built-in charger, two joists, four material supports and a parking bracket for the steering handle.

ALSO AVAILABLE WITH REMOTE CONTROL

ErgoMover Go is available as Wireless, without the drawbar and operator handle. All the functions of the trolley are controlled via radio or cable remote control - depending on which you prefer to use. The Wireless model is particularly suitable for long loads and/or tight spaces.



ErgoMover Go 360°

- with 360° rotatable platform. Suitable for areas with limited space.



OPTION: Extension, suitable for transport of long loads.

SPECIFICATIONS*

Lifting capacity:	1.500 kg
Length, table:	1.620 mm
Width, table:	698 mm
Total Width:	701 mm
Total length w. handle down:	3.021 mm
Total length Wireless:	1.680 mm
Height:	593 mm
Weight, w. drawbar:	300 kg
Weight, Wireless:	307 kg
Turning radiusF:	~ 3,5 m
Voltage:	24 Volt
Speed:	0-6 km/h

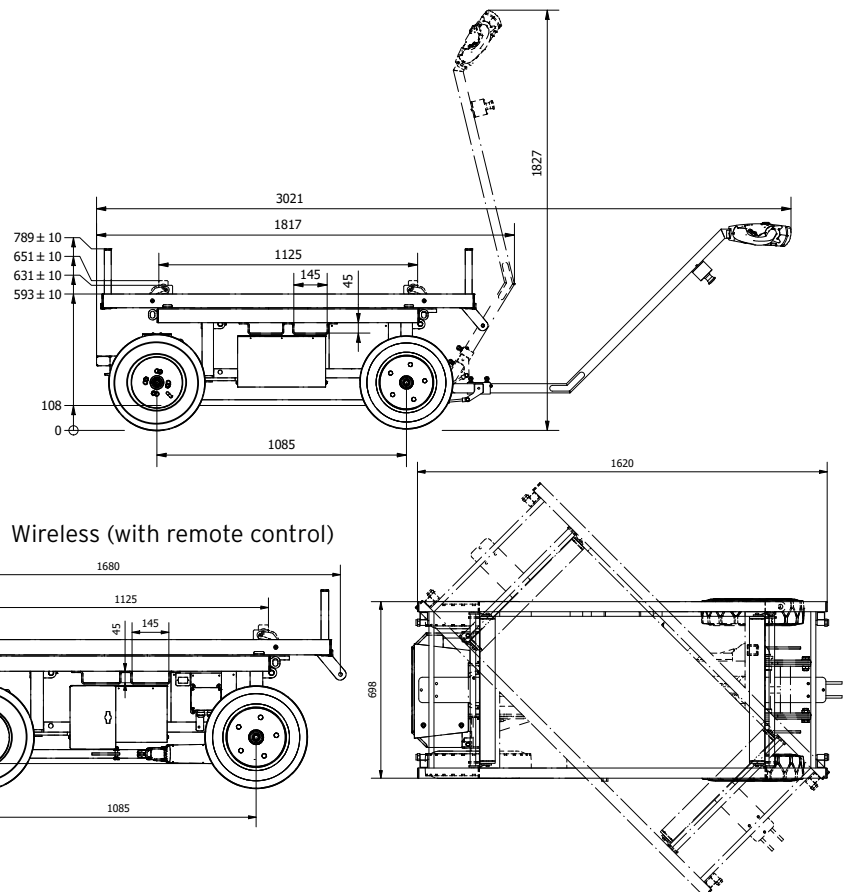

Wireless (with remote control)

*The dimensions are indicative and may vary +/- 10mm

ErgoMover Go Cargo

- with lashing eyes. Suitable for transporting e.g. glass racks.



SPECIFICATIONS*

Lifting capacity:	1.500 kg
Length, table:	1.510 mm
Width, table:	835 mm
Total Width:	835 mm
Total length w. handle down	3.021 mm
Total length Wireless:	1.574 mm
Height:	556 mm
Weight, w. drawbar:	304 kg
Weight, Wireless:	311 kg
Turning radius:	~ 3,5 m
Voltage:	24 Volt
Speed:	0-6 km/h

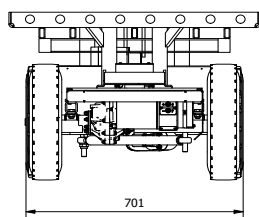
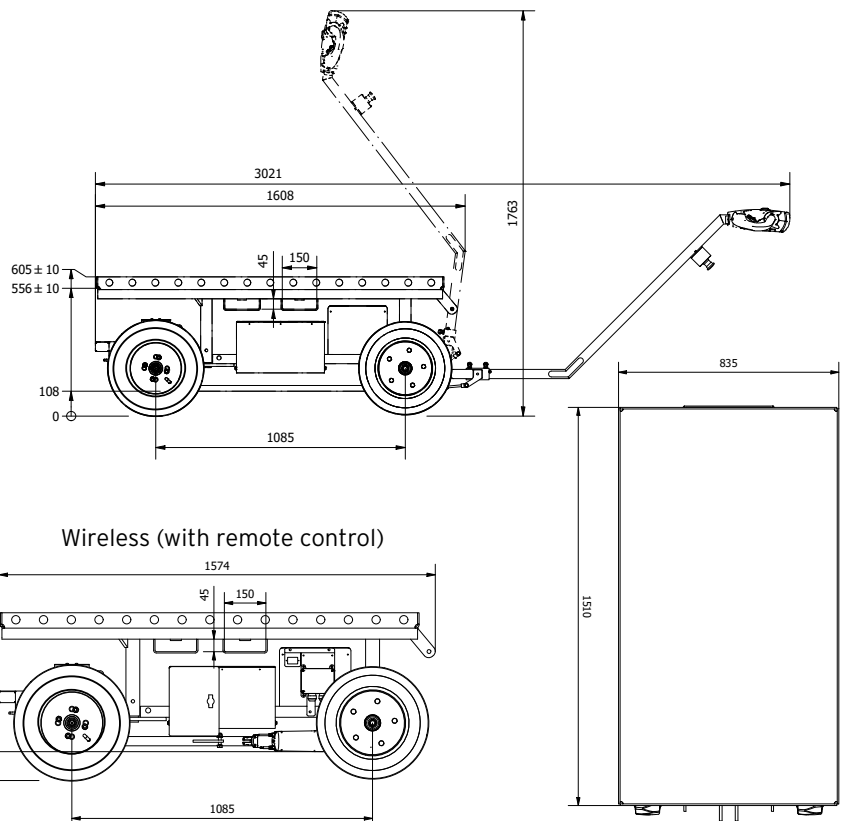

*The dimensions are indicative and may vary +/- 10mm

ErgoMover Go Low

- is characterized by an extra low platform and low center of gravity.



OPTION: Extension, suitable for transport of long loads.

SPECIFICATIONS*

Lifting capacity:	1.500 kg
Length, table:	1.620 mm
Width, table:	698 mm
Total Width:	830 mm
Total length w. handle down:	3.021 mm
Total length Wireless:	1.702 mm
Height:	531 mm
Weight, w. drawbar:	280 kg
Weight, Wireless:	287 kg
Turning radius:	~ 3,5 m
Voltage:	24 Volt
Speed:	0-6 km/h

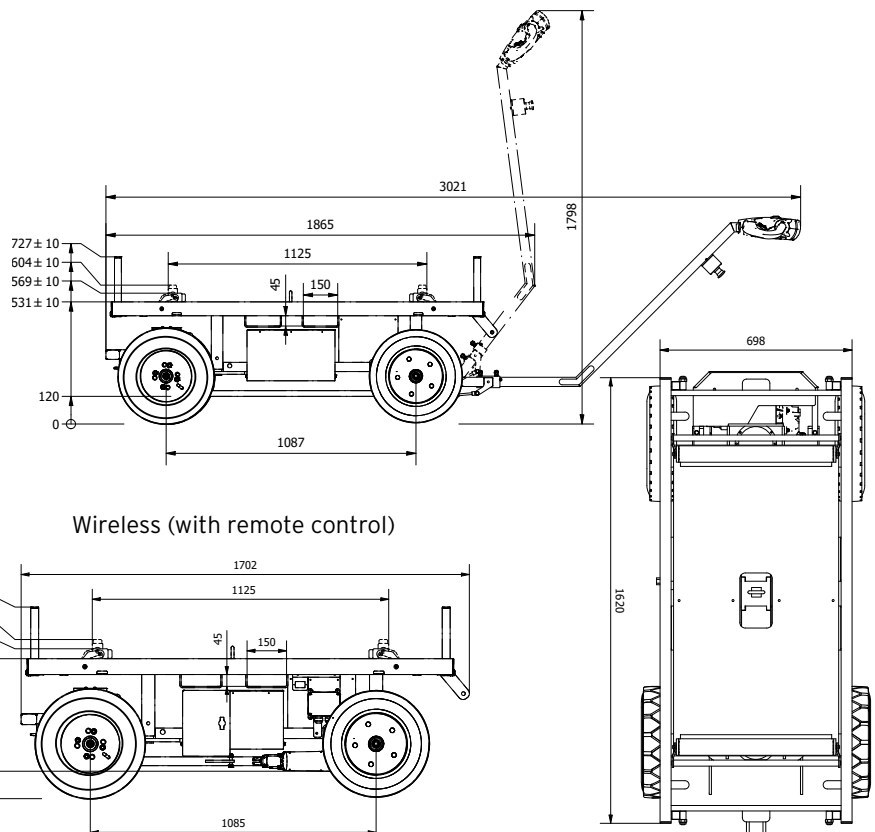

*The dimensions are indicative and may vary +/- 10mm

ErgoMover Go XL Low

- Low version with a table of 2x1 m. Suitable for transporting large items.



➔ OPTION: Extension, suitable for transport of long loads.

SPECIFICATIONS*

Lifting capacity:	1.500 kg
Length, table:	2.010 mm
Width, table:	1.000 mm
Total Width:	1.000 mm
Total length w. handle down:	3.197 mm
Total length Wireless:	2.074 mm
Height:	531 mm
Weight, w. drawbar:	321 kg
Weight, Wireless:	328 kg
Turning radius:	~ 3,5 m
Voltage:	24 Volt
Speed:	0-6 km/h

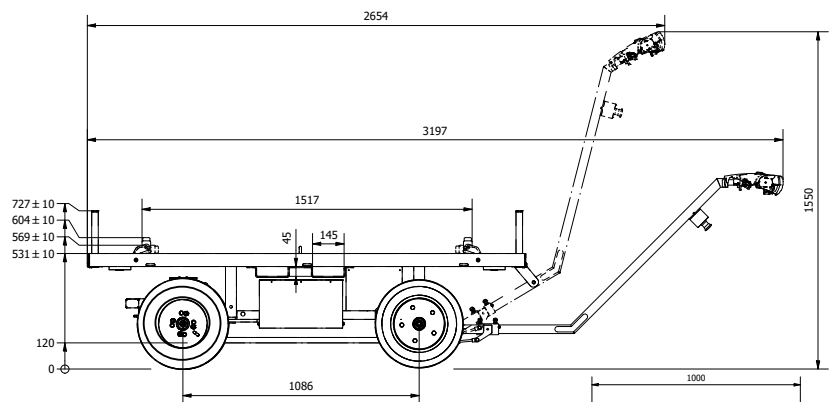

Wireless (with remote control)

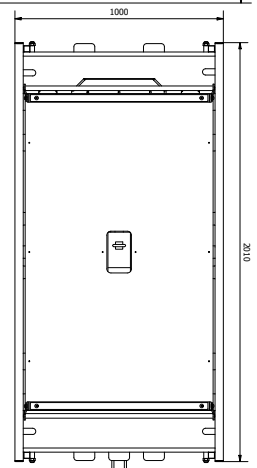
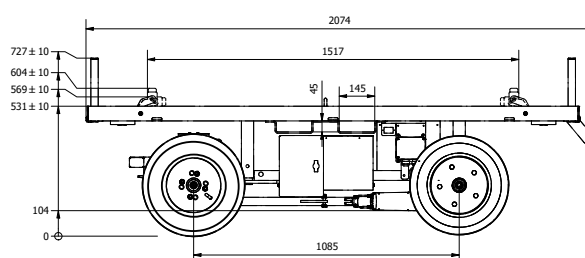
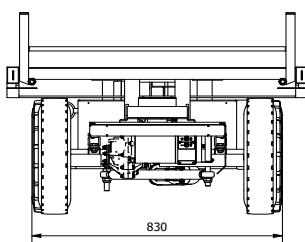

*The dimensions are indicative and may vary +/- 10mm

ErgoMover Go XL

- with a table of 2x1 m. Suitable for transporting large items.



OPTION: Extension, suitable for transport of long loads.

SPECIFICATIONS*

Lifting capacity:	1.500 kg
Length, table:	2.010 mm
Width, table:	1.000 mm
Total Width:	1.000 mm
Total length w. handle down:	3.198 mm
Total length Wireless:	2.074 mm
Height:	575 mm
Weight, w. drawbar:	331 kg
Weight, Wireless:	338 kg
Turning radius:	~ 3,5 m
Voltage:	24 Volt
Speed:	0-6 km/h

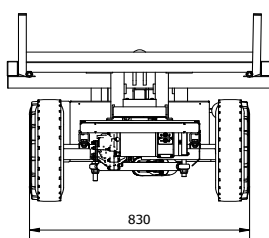
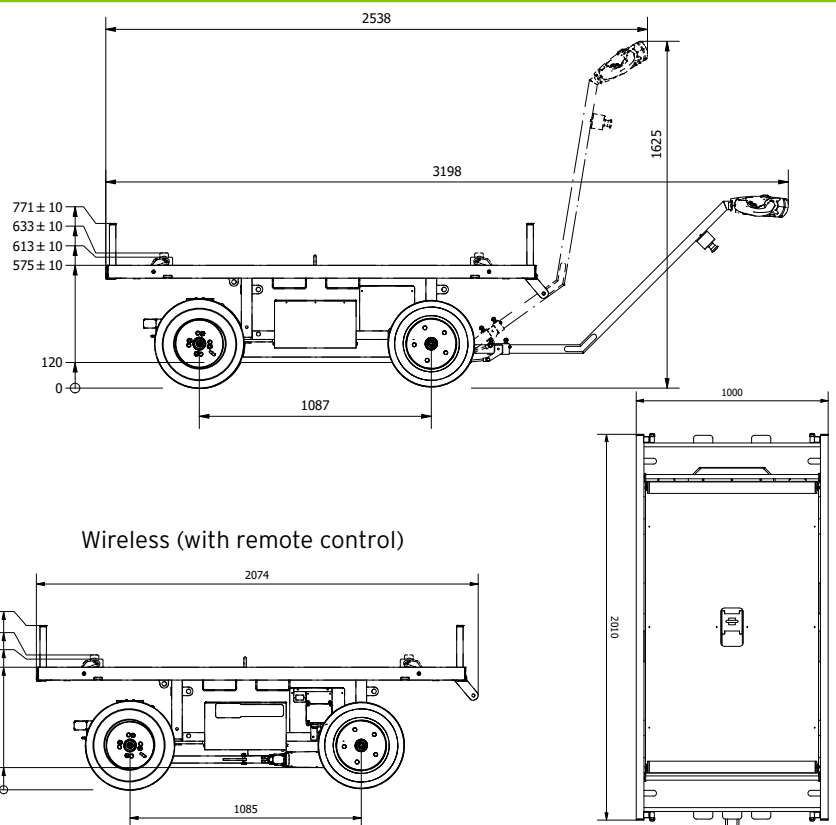

*The dimensions are indicative and may vary +/- 10mm

ErgoMover Go Ground protection mats

- with a table of 2x1 m. and corner extension, which allows adjustment to different mat sizes.



➔ With variable corner extension. Allows adjustment for different plate sizes.

SPECIFICATIONS*

Lifting capacity:	1.500 kg
Length, table:	1.905 - 2.460 mm
Width, table:	963 - 1.240 mm
Total Width:	963 - 1.240 mm
Total length w. handle down:	3.231 mm
Total length Wireless:	1.917 mm
Height:	633 mm
Weight, w. drawbar:	342 kg
Weight, Wireless:	354 kg
Turning radius:	~ 3,5 m
Voltage:	24 Volt
Speed:	0-6 km/h

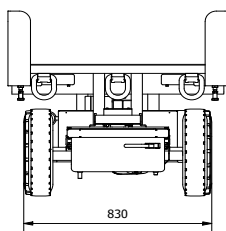
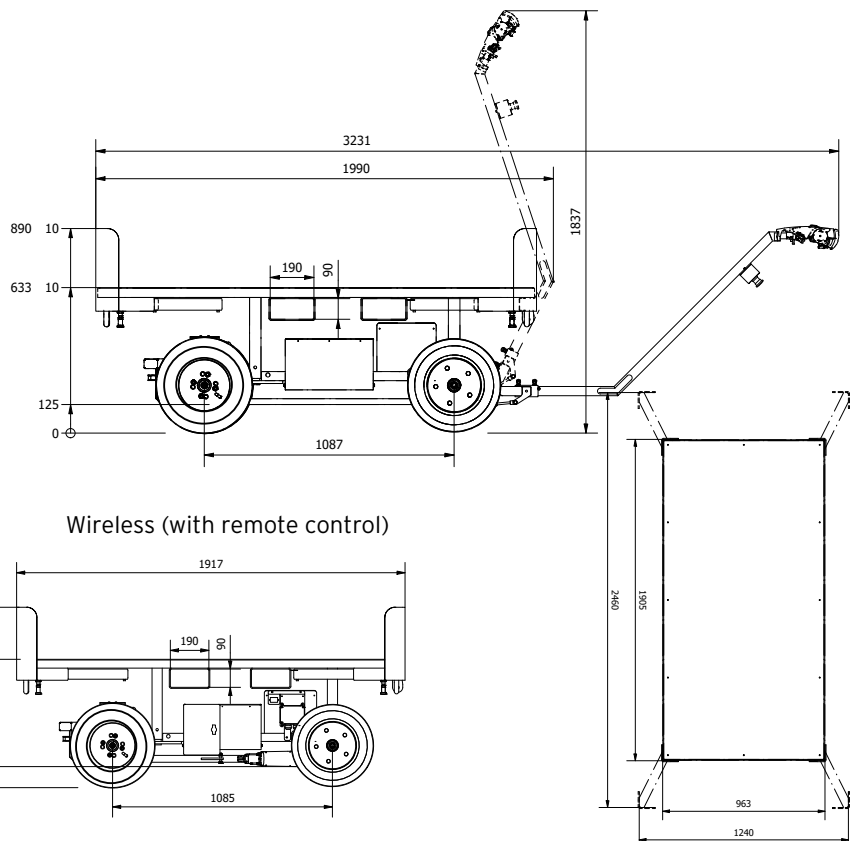

*The dimensions are indicative and may vary +/- 10mm



ErgoMover Lift & Go

ErgoMover Lift & Go is an electric battery powered transport trolley with hydraulic lift of the flat bed. The trolley is developed to replace the manual plasterboard trolleys by assisting in manual heavy lifting tasks and optimising the handling of plasterboards and other building materials.

LARGE CAPACITY

The trolley has a powerful electric motor and 4-wheel steering and is suitable for driving off-road and on construction sites.

The ErgoMover Lift & Go is able to lift the flat bed by 150mm which makes it ideal, for example, for placing plasterboards on trestles. It can transport and lift an impressive 1.500 kg.

OPTION: Extension, suitable for transport of long loads.



ErgoMover Lift & Go

SPECIFICATIONS*

Lifting capacity:	1.500 kg
Transport of plates up to:	3.000 mm
Length, table:	1.620 mm
Width, table:	698 mm
Total Width:	701 mm
Total length w. handle down:	3.021 mm
Total length Wireless:	1.702 mm
Height, Min / Max:	572 / 768 mm
Weight, w. drawbar:	319 kg
Weight, Wireless:	326 kg
Turning radius:	~ 3,5 m
Voltage:	24 Volt
Speed:	0-6 km/h

! Min. trestle height: 660 mm.

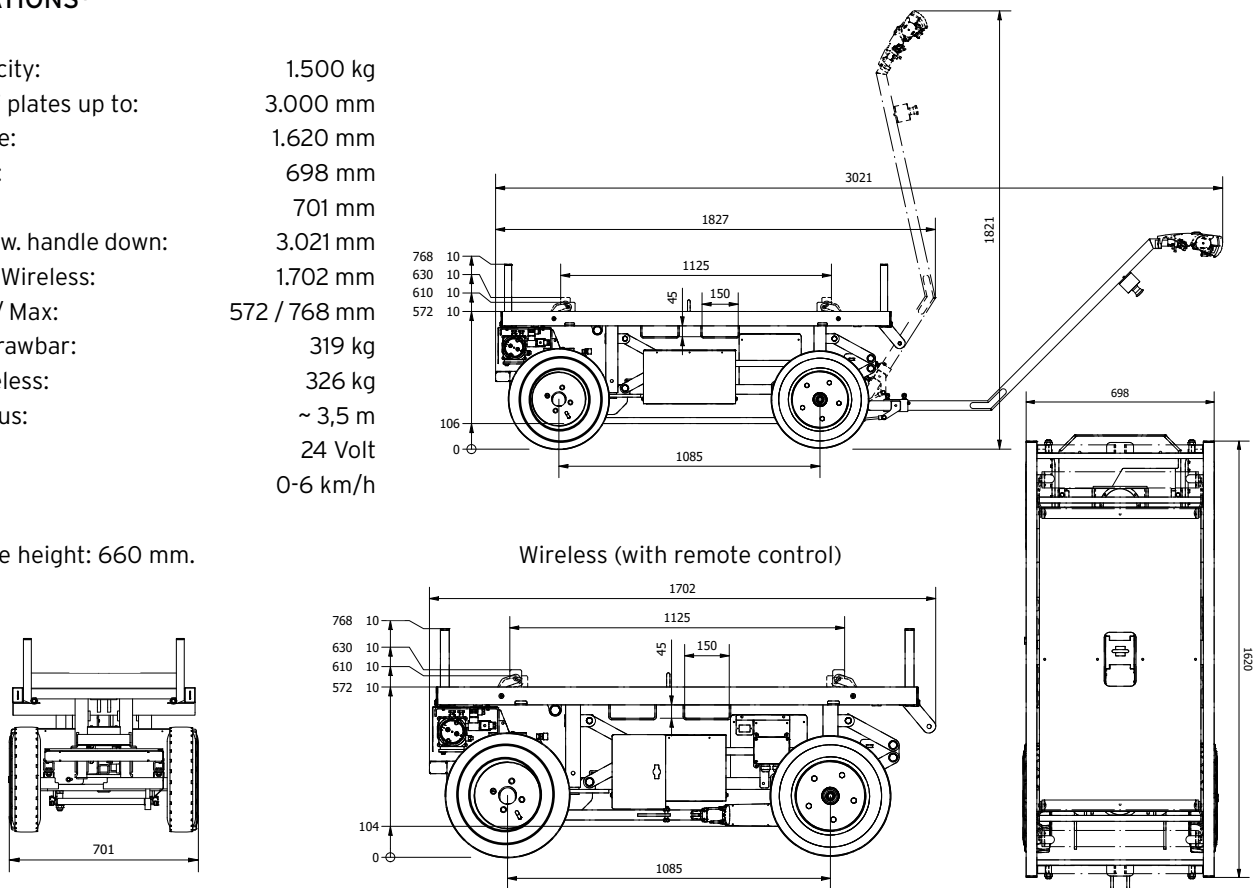

*The dimensions are indicative and may vary +/- 10mm

UNIQUE USABILITY AND SAFETY

The ErgoMover Lift & Go is equipped with an ergonomic and user-friendly handle with built-in safety functions which lives up to the strictest safety norms.. The belly button makes sure the operator is not caught between machine and the wall. Safety device will bring the machine to a complete stop when you let go of the handle. The ErgoMover Lift & Go is also equipped with a built-in charger, two joists, four material supports and a parking bracket for the steering handle.

ALSO AVAILABLE WITH REMOTE CONTROL

ErgoMover Lift & Go is available as Wireless, without the drawbar and operator handle. All the functions of the trolley are controlled via radio or cable remote control - depending on which you prefer to use. The Wireless model is particularly suitable for long loads and/or tight spaces.



ErgoMover Lift & Go 360°

- with hydraulic lift and 360° rotatable table. Suitable for areas with limited space.



SPECIFICATIONS*

Lifting capacity:	1.500 kg
Length, table:	1.620 mm
Width, table:	698 mm
Total width:	701 mm
Total length w. handle down:	3.021 mm
Total length Wireless:	1.702 mm
Height, Min / Max:	595 / 791 mm
Weight, w. drawbar:	331 kg
Weight, Wireless	404 kg
Turning radius:	~ 3,5 m
Voltage:	24 Volt
Speed:	0-6 km/h

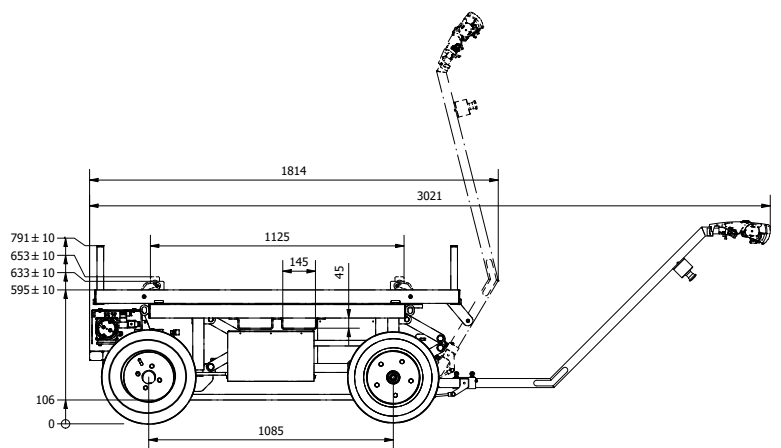

! Min. trestle height: 700 mm.

Wireless (with remote control)

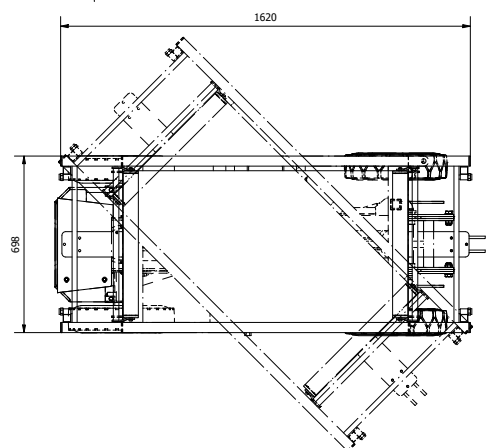
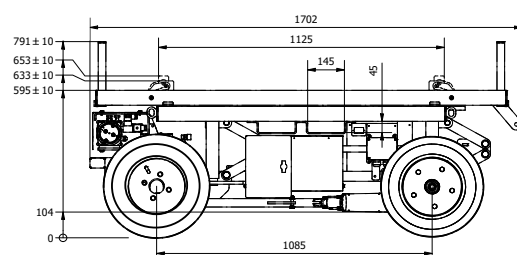
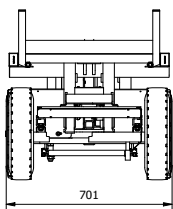

*The dimensions are indicative and may vary +/- 10mm

ErgoMover Lift & Go XL

- with hydraulic lift and a table of 2x1 m.



➔ OPTION: Extension, suitable for transport of long loads.

SPECIFICATIONS*

Lifting capacity:	1.500 kg
Length, table:	2.010 mm
Width, table:	1.000 mm
Total width:	1.000 mm
Total length w. handle down:	3.197 mm
Total length Wireless:	2.074 mm
Height, Min / Max:	572 / 768 mm
Weight, w. drawbar:	361 kg
Weight, Wireless	368 kg
Turning radius:	~ 3,5 m
Voltage:	24 Volt
Speed:	0-6 km/h

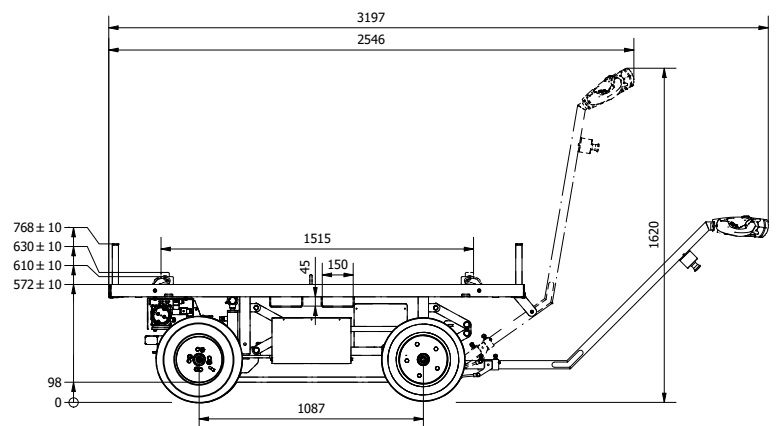

! Min. trestle height: 660 mm.

Wireless (with remote control)

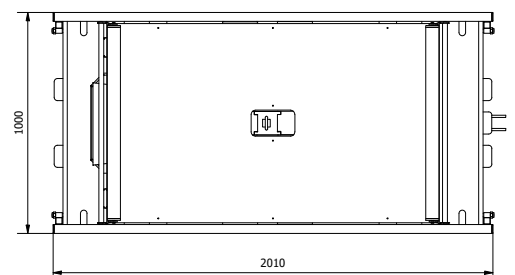
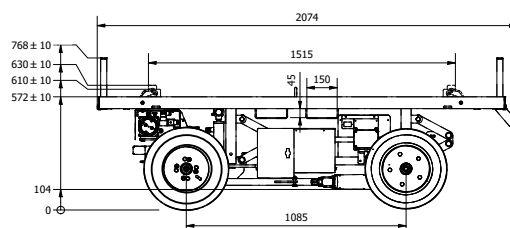
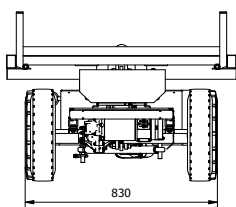

*The dimensions are indicative and may vary +/- 10mm



ErgoMover Manipulator

The ErgoMover Manipulator is a unique self-propelled plate trolley which, besides being able to set down stacks of plasterboards on trestles, can also raise a stack of plasterboards to the vertical position.

Boards up to 3.000 mm can be set down on an ErgoLoader, so the ErgoMover is free to pick up another stack or the stack can be left on the ErgoMover and be mounted on the wall individually with the ErgoMounter.

The ErgoMover Manipulator, Ergoloader and ErgoMounter are three unique units that together form a system for efficiently transporting whole stacks of plasterboard all the way from the truck to the wall without at any time requiring manual lifting of a single board.



ErgoMover Manipulator

SPECIFICATIONS*

Lifting capacity when driving:	1.200 kg
Lifting capacity when tilting:	1.100 kg
Transport of plates up to:	3.000 mm
Length, table:	1.635 mm
Total length w. handle down:	3.671 mm
Width:	701 mm
Height, Min / Max:	590 / 786 mm
Weight:	457 kg
Turning radius:	~ 3,5 m
Voltage:	24 Volt
Speed:	0-6 km/h

! Min. trestle height: 660 mm.

SAFETY

All lifting and tilting functions are done by a powerful electric hydraulic system with built-in safety features.

The ErgoMover Manipulator has been developed in collaboration with professional users and meets all requirements for safe and reliable operation.

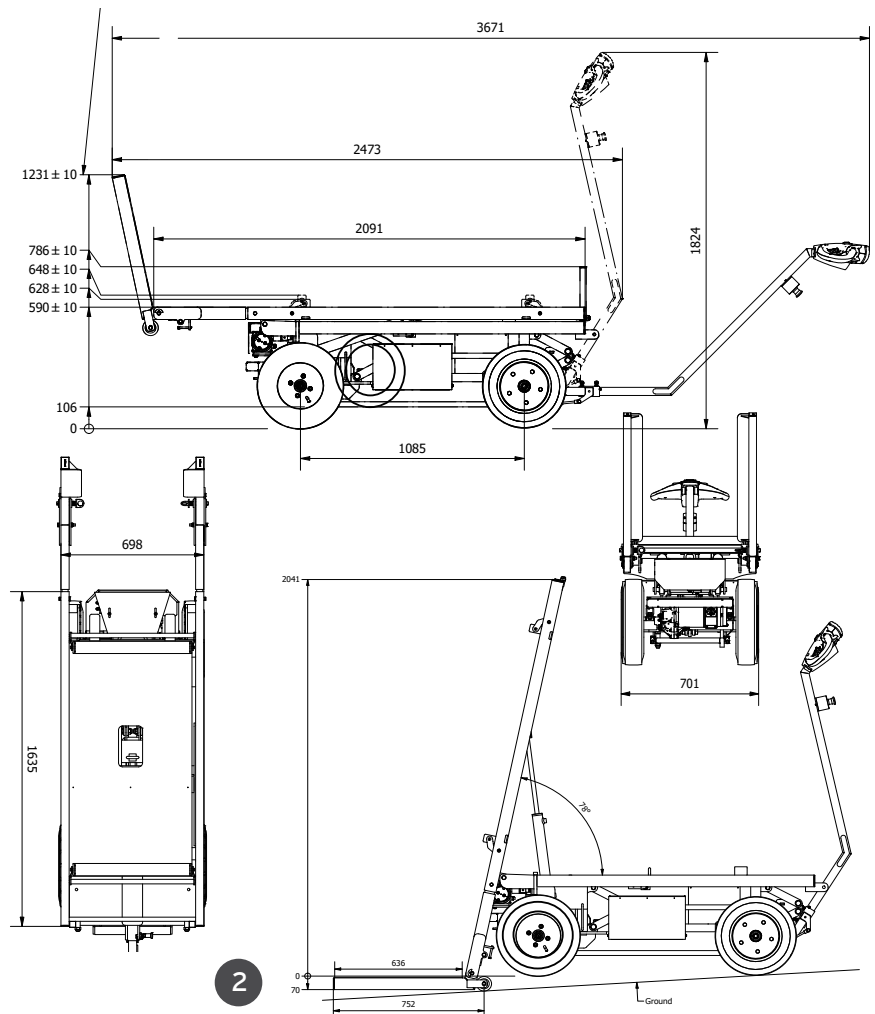

1

ERGOLOADER

The ErgoLoader - the efficient mobile plate rack with wheels that can receive an ENTIRE pallet of plasterboard (42 sheets) in the upright position directly from the ErgoMover Manipulator. The plasterboards are then stored on the ErgoLoader until they are to be mounted onto the wall. Hereby they take up a minimum of floor space. The ErgoLoader is safely and easily handled by one person.

The ErgoLoader comes with two sets of forks:

- Long forks for a full pallet of plasterboards (42 sheets)
- Short forks for half pallets (21 sheets)

When the short forks are mounted, the ErgoLoader can pass through a door opening with half a pallet of plasterboard.

2

ERGOMOUNTER

The ErgoMounter is a unique plasterboard mounting trolley for ergonomic and efficient fitting of drywalling.

When mounting plasterboard on walls, it is now possible with ErgoMover Manipulator and ErgoMounter, to transport full pallets of plasterboard directly from the crane and raise them to the vertical position for mounting on the wall without any back strain

The ErgoMounter is a flexible tool that can be used for mounting all panel widths and - heights. The unique design means that ErgoMounter can be stored with a plate ready for installation. Large pneumatic wheels for maneuverability - even in often very uneven floors.

*The dimensions are indicative and may vary +/- 10mm

So easy with ErgoMover...

From delivery to installation

- 1 ErgoMover picks up stacks of drywall directly from truck

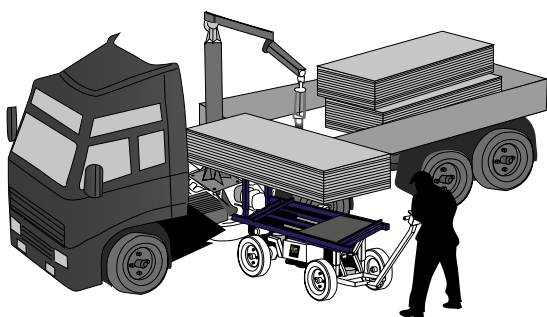

NB!

Tilting of a whole stack of drywall.
For both whole and half stacks of drywall!

- 2 Moving inside building with powered wheel drive

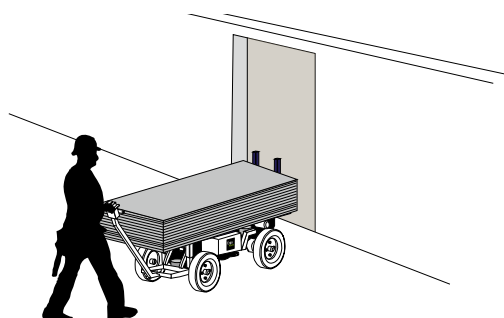

- 3 Horizontal unloading of stacks of drywall on trestles or vertical unloading of stacks of drywall in ErgoLoader



- 4 Picking up plates - ready to install on wall



- 5 ErgoMounter Installing drywall on steel or wooden frame system



SPECIFICATIONS*

Lifting capacity:	1.500 kg
Length, without handle:	1.700 mm
Width:	700 mm
Weight:	275 kg
Voltage:	24 Volt
Speed:	0-6 km/h

UNIQUE USABILITY AND SAFETY

The ErgoMover GO OEM is equipped with an ergonomically and user-friendly handle with built-in safety functions which lives up to the strictest safety norms.. The belly button makes sure the operator is not caught between machine and the wall. Safety device will bring the machine to a complete stop when you let go of the handle.

The ErgoMover Go OEM is also equipped with a built-in charger and a parking bracket for the steering handle.

**The dimensions are indicative and may vary +/- 10mm*

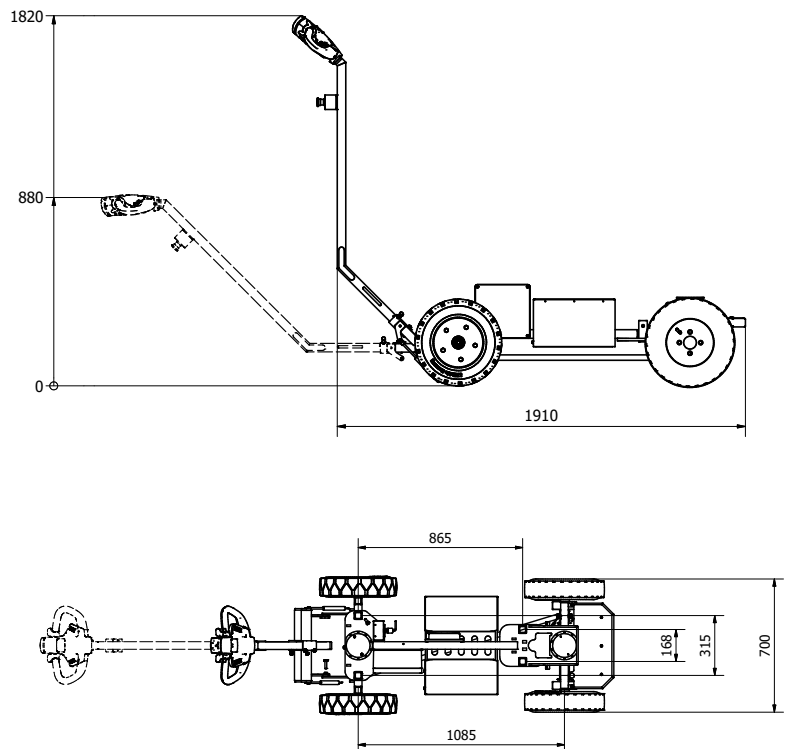

ErgoMover Go OEM

As something completely new we are offering you the possibility to only purchase an ErgoMover Go undercarriage without the platform. This gives you the opportunity to adjust the trolley exactly as you wish.

The undercarriage has all the excellent qualities from the ErgoMover Go, like the powerful electric motor and 4-wheelsteering which makes it ideal for driving in an outdoor terrain.

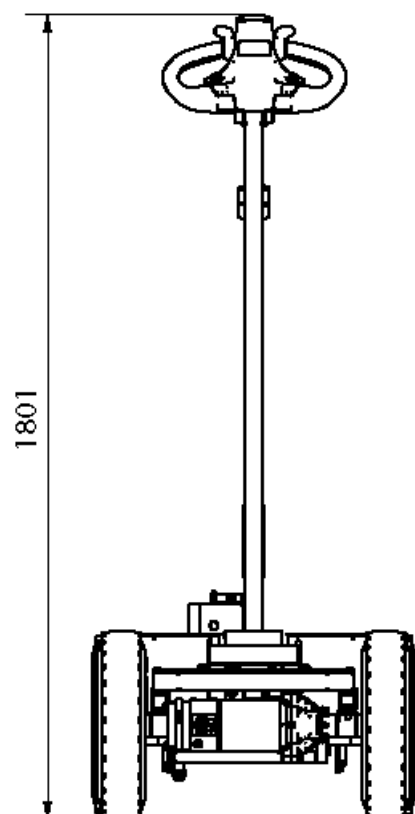



ErgoMover Accessories

Make the most of your ErgoMover

ErgoMover comes with a wide range of accessories.

Here is a few of our most popular items:

- NON-MARKING WHEELS
- PROTECTION COVER FOR HANDLE
- PLASTERBOARD TRESTLES
 - Max load of 400 kg. apiece
- TUBE FOR USER MANUAL
- GLASS RACK
- RADIO REMOTE
- CABLE REMOTE
- CABINET FOR CHARGER AND REMOTE CONTROL
- JOISTS ON EXTENSION

Please consult our experts to find the right accessories for your ErgoMover.



With **GMV** you also get...



Effective and safe lifting of windows, glass and other airtight materials with **Winlet**

The Winlet product range is a series of self-propelled glazing robots which uses hydraulics and vacuum to lift and handle sheet glass, windows and other airtight materials. The movements of Winlet is hydraulically actuated which ensures optimal control both at high speed and during more demanding precision work. All movements are 100% linear, which is crucial when installing glass and windows.

www.winlet.dk



GMV A/S was founded in 1988. In 2008, the company was acquired by Jesper Faurskov and Erik Pedersen. In 2025, GMV became part of the Amplex Group, marking a significant expansion of the company's reach and capacity. The vision of GMV is:

GMV must be at the cutting edge of market needs, and match these needs by developing unique technical solutions which aid heavy manual lifting with modern design.

A HEALTHY WORKING ENVIRONMENT MEANS HAPPY EMPLOYEES

GMV provides solutions for heavy manual lifting for the building and manufacturing industries.

CONSULTING, ENGINEERING AND PLANNING

We are with you from start to finish. We provide qualified advice and listen to your needs.

THE MARKETS BEST SOLUTIONS AND PRODUCT BRANDS

We provide innovative solutions that suit your needs.

LOCAL COMPANY WITH GLOBAL SALES

With our strong dealer network, we sell products worldwide.

EDUCATION AND SERVICE

Our highly trained experts guide and instruct distributors and end users.

ASSEMBLY AND MAINTENANCE CHECK

Our strong team is responsible for assembly and service, both locally and internationally.

PRODUCT DEVELOPMENT

GMV develops products from scratch. Focus is always on a good working environment.

MODERN INDUSTRIAL DESIGN

Our award-winning Danish design is combined with unique technical solutions for both the building and manufacturing industries.

DANISH PRODUCTION LINE ACCORDING TO EUROPEAN STANDARDS

We have our own local production and use local suppliers. This ensures local jobs and high quality.

THOROUGH FACTORY TESTING AND DOCUMENTATION

All of our products undergo rigorous testing before leaving the factory and comprehensive technical documentation always accompanies our products.

TRAINING FOR SERVICE TECHNICIANS

To ensure that our products last as long as possible and that local laws are respected, we conduct thorough training with your service technicians - both nationally and internationally.



GMV A/S
Industriparken 1
DK - 7182 Bredsten

Tel: +45 7573 8247
E-mail: post@gmvas.dk